

Installation, Operation & Maintenance Manual

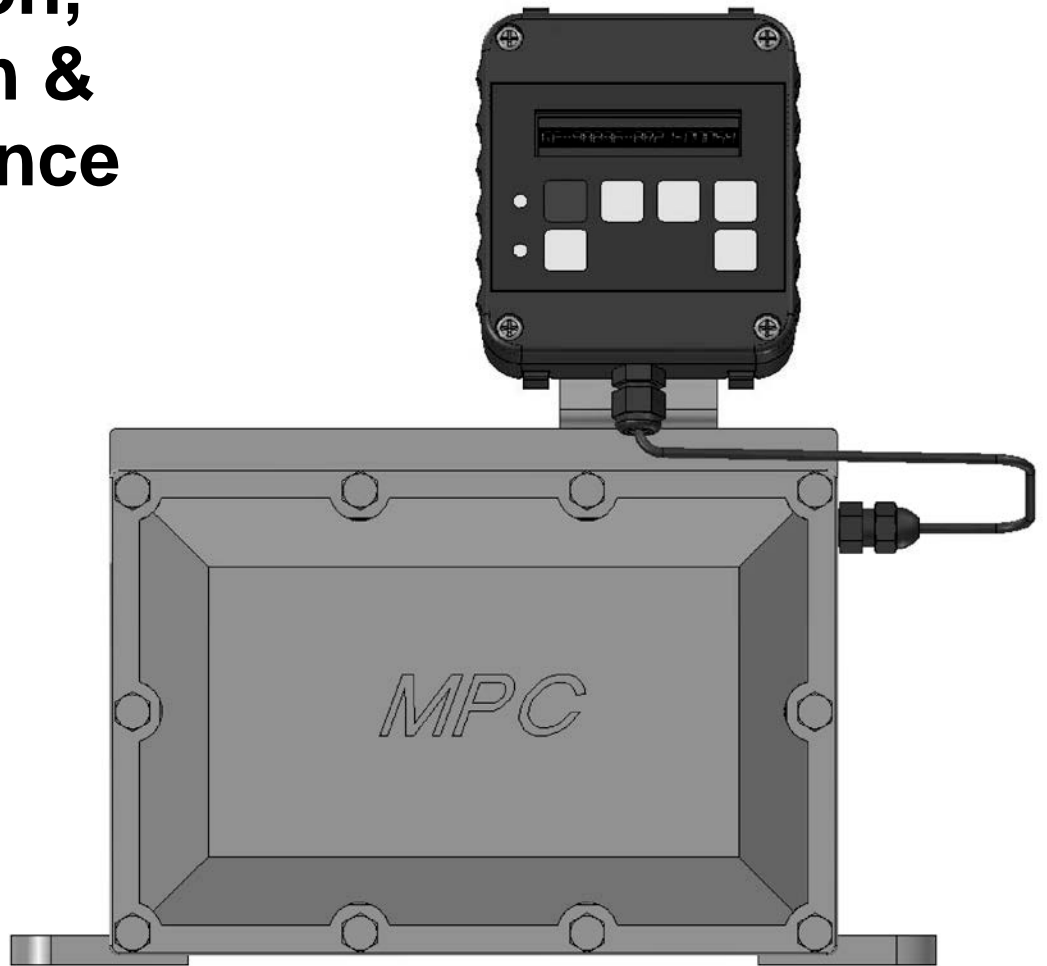

MPC™ FACTORY SERVICE POLICY

Your MPC is a state of the art microprocessor based motor speed control for use with Pulsafeeder Diaphragm Metering Pumps. It includes extensive on-board diagnostics. If you are experiencing a problem with your MPC, first review the on-screen information, then consult the troubleshooting guide. If the problem is not covered or cannot be solved, please contact your local authorized Sales Representative or our Technical Service Department at (585) 292-8000 for further assistance.

Trained individuals are available to diagnose your problem and arrange a solution. Solutions may include purchasing a replacement unit or returning the MPC to the factory for inspection and repair. All returns require a Return Material Authorization (R.M.A.) number to be issued by Pulsafeeder. Replacements purchased under a possible warranty situation may be credited after an examination of the original MPC by Pulsafeeder personnel.

Certain components may be purchased for replacement. Refer to **Section 19 – Maintenance & Spare Parts** for more information and part numbers. Parts purchased to correct a warranty issue may be credited after examination of the original parts by Pulsafeeder personnel. Parts returned for warranty consideration that test satisfactorily, will be sent back to the originator via freight collect.

Any field modifications will void the Pulsafeeder MPC warranty. Out-of-warranty repairs will be subject to Pulsafeeder's standard bench fees and testing costs associated with replacement components.

FCC Warning

This equipment generates and uses radio frequency energy. If not installed and used properly, in strict accordance with the manufacturer's instructions, it may cause interference to radio communications. Operation of this equipment in a residential area is likely to cause interference. In such cases, the user at their own expense will be required to take whatever measures necessary to correct the interference.

Copyright

Copyright © 2007-2014 Pulsafeeder, Inc. All rights reserved.

Information in this document is subject to change without notice. No part of this publication may be reproduced, stored in a retrieval system or transmitted in any form or any means electronic or mechanical, including photocopying and recording for any purpose other than the purchaser's personal use without the written permission of Pulsafeeder.

Table of Contents

INSTALLATION, OPERATION & MAINTENANCE MANUAL	I
MPC™ FACTORY SERVICE POLICY	I
TABLE OF CONTENTS.....	III
FOR THE REMAINDER OF THIS BULLETIN, THE FOLLOWING CONVENTIONS ARE IN EFFECT.	V
1. INTRODUCTION	1
2. FORWARD	1
3. DESCRIPTION	1
3.1 MPC Standard Features	2
3.2 Options	3
4. SAFETY CONSIDERATIONS	3
4.1 General Safety	3
4.2 Electrical Safety	3
4.3 Fire Safety	3
4.4 Mechanical Safety	4
4.5 Hydraulic Safety	4
4.6 Liability Exclusion	4
5. PUMP SUITABILITY TO SITE OF INSTALLATION	5
6. TRANSPORT AND STORAGE.....	6
6.1 Consignment receipt and unpackaging	6
6.2 Handling	6
6.3 Lifting.....	6
6.4 Recycling and end of product life.....	6
7. STORAGE INSTRUCTIONS	8
7.1 Short Term (0 - 12 months).....	8
7.2 Long Term (12 months or more).....	8
8. INSTALLATION AND WIRING	9
8.1 Location.....	9
8.2 Installation Notes.....	10
8.3 Installation guidelines for EMC compliance	10
8.3.1 The cover must be installed properly.....	10
8.3.2 Shielded cables used for analog inputs and outputs	10
8.3.3 Proper Earth grounding	10
8.3.4 Ensure Power mains are properly filtered for isolation from line transients,.....	10
8.3.5 Lightning strikes or other electrical noise sources.....	10
8.4 Electrical Wiring	11
8.4.5 Analog input signals, so the MPC can accept a process input signal.....	11
8.4.6 Power Wiring Information	14
8.4.7 Power Wiring Diagram	15
8.4.8 Control Input/Output Signal Wiring	18
8.5 Check Wiring and Close Access Cover	20
8.6 Confirm Correct Incoming Power	20
9. START UP AND OPERATION.....	22
9.1 Overview.....	22
9.2 Keypad/Lamp Operation	23
9.3 Confirm Display and Keypad Functionality	23
9.4 Flow Display.....	24
9.5 Wrapping up.....	24
10. INPUT/OUTPUT SETUP.....	26
10.1 Analog Input Setup.....	26

10.2	Digital Input Setup	26
10.3	Analog Output Setup	26
10.4	Digital Output Setup	26
10.5	Pump Flow Calibration	27
10.6	Analog Input Calibration	31
10.7.	Analog Output Calibration	34
10.8	Display Contrast Adjustment	35
10.9	Changing the Motor Base Frequency	35
11.	ALARM AND ERROR MESSAGES	36
12.	EXTENDING YOUR HAND-HELD CONTROLLER	38
12.1	Obtain New Cable:	38
12.2	Removal and Connection of the Cable from the Handheld:	38
13.	SPECIFICATIONS	42
14.	MENU MAPS	45
15.	FACTORY DEFAULT VALUES	47
16.	RETRIEVAL OF SETUP INFORMATION	47
17.	SPECIAL KEYPRESS ACCESS	47
18.	TROUBLESHOOTING GUIDE	48
19.	MAINTENANCE & SPARE PARTS	49
19.1	Operating Precautions	49
19.2	Cleaning and Decontamination	49
19.3	User Replaceable Parts for the MPC	50

Conventions

For the remainder of this bulletin, the following Conventions are in effect.



A WARNING DEFINES A CONDITION THAT COULD CAUSE DAMAGE TO BOTH THE EQUIPMENT AND THE PERSONNEL OPERATING IT. THIS MANUAL MUST BE CONSULTED IN ALL CASES WHERE THE WARNING SYMBOL IS MARKED IN ORDER TO FIND OUT THE NATURE OF THE POTENTIAL HAZARDS AND ANY ACTIONS WHICH HAVE TO BE TAKEN TO AVOID THEM.



CAUTION, POSSIBILITY OF ELECTRIC SHOCK AND/OR ELECTROCUTION HAZARD!



Notes are general information meant to make operating the equipment easier.



Tips have been included within this bulletin to help the operator run the equipment in the most efficient manner possible. These “Tips” are drawn from the knowledge and experience of our staff engineers, and input from the field.

Revision History:

Rev E (3-25-05)

- Section 3.1 Description, added 3-phase vs. single-phase info
- Change description of digital output specification
- New figure 2 (pump mounting)
- Updated analog in, analog out, and flow calibration instructions
- Update error handling text, Section 11
- Add specifications for voltage range and ELCB's
- Add safety warnings about inrush current and capacitor discharge throughout

Rev F (7-25-06)

- Added nametag diagram and note on proper input voltage selection on page 9
- Added section 8.5 on adjusting motor base frequency
- Added sample digital output diagram in section 5.3.4

Rev H (9-26-07)

- Added clarification on digital output capability, *sections 1.2, 5.3.4, and 7.4*
- Motor information added, *sections 1.2, 1.3, and 11*
- Added missing step in calibration instructions, *section 8.1.1*

Rev I (05-22-2014)

- Updated to reflect requirements of UL 61010-1 3rd Edition

1. Introduction

The Metering Pump Controller (MPC) is a microprocessor based motor speed control device, for use with Pulsafeeder mechanical and hydraulic diaphragm metering pumps. It has been designed for simplicity, yet still has many advanced features that allow the MPC to operate in a wide variety of environments and applications.

This instruction manual covers the MPC only. All standard features are covered in this manual and most options have instructions where applicable. For information specific to the metering pump or any other accessories, please refer to the appropriate IOM.

2. Forward

The pumps to which these “instructions” refer to are designed for use in industrial areas and therefore cannot be treated as retail products. The present documentation gives instructions to be used by qualified personnel only. It must be used in compliance with the regulations, laws and technical standards in force and cannot, under any circumstances, take the place of plant standard or additional regulations, including any which are not legally enforceable, which have been issued with the scope of ensuring safety.

Equipment with special manufacturing or constructive variances may differ in details with respect to this description.

In case of any difficulty, please contact PULSAFEEDER, INC. Technical Service.

The MPC is rated for NEMA 4x locations as identified on the controller nameplate.

3. Description

The MPC is an advanced pump controller that is physically attached to the pump. Its purpose is to precisely adjust output flow of a process media by means of pump motor speed control.

The MPC is designed for a wide variety of control applications. The device is factory configured and calibrated for the attached pump. The human/machine interface is user friendly. Local setup and control is achieved through the keypad and a backlit two-line liquid crystal display. Basic operation is simple with dedicated function keys eliminating the need for a sophisticated menu system. The MPC responds immediately to user commands. Pump output is displayed as Gallons per Hour (GPH), Liters per Hour (LPH), Strokes per Minute (SPM), Percent Speed, or Percent Flow (% of total pump capacity).

Digital and analog inputs will support a variety of industry standard signals to offer flexible remote control.

The MPC is designed to simplify and automate the calibration of pump flow and analog signals. Flow calibration uses on-screen prompting and automated pump operation to eliminate stopwatches, calculators and human inaccuracies. Analog signal calibration is also accomplished by simple keypad entry. It

includes a real-time display of signal level. This eliminates the need for external meters.

The MPC readily accepts PULSAlarm[®] leak detection and tank level inputs. These may be configured to stop the pump and/or activate an alarm relay.

The MPC is factory configured to operate at either 60 Hz or 50 Hz input. No special modifications, settings, or adjustments are required. All MPC controllers are supplied with a motor rated at 60 Hz, regardless of the supply frequency. The controller/motor combination allows for full pump speed and flow even when operating from a 50 Hz input. Users in locations with 50 Hz AC supply do not have to de-rate pump flow with this controller.

The motor used with the MPC is a three-phase motor; however the three-phase power is generated internally by the MPC itself. Do not be confused by the motor nameplate. Input power to the MPC is single-phase AC only; either 115 or 230 volts (see **Section 13, Specifications** for acceptable input voltage range). The nameplate on the rear of the MPC controller lists the appropriate supply requirements.

At lower stroke frequencies (below 3:1 turndown), the MPC employs intermittent motor actuation technology. This allows the user to achieve reliable low-end performance not usually associated with variable speed controllers. By completing a full pump stroke at constant speed, and varying the interval between strokes, hydraulic stability and process consistency is maintained.

The AC drive used in the MPC maintains tight control over voltage and current supplied to the pump motor. This results in lower motor operating temperatures and less stress on motor windings, resulting in longer motor life and more reliable overall operation. This holds true even when metering in the lower flow ranges where the MPC uses intermittent operation.

3.1 MPC Standard Features

- Remote keypad and display for ease of operation
- Display pump flow in GPH, LPH, Strokes per Minute, or % of full pump flow
- One 4-20 mA analog input signal for flow control
- One 4-20 mA analog output signal for flow feedback
- Two configurable digital inputs
- Three configurable digital outputs
- Advanced turndown capability
- NEMA 4X and IP56 ratings
- Available for 115 or 230 Volts, 50 or 60 Hz, single phase AC power
- Security code lockout of menus
- Commercial duty motor as standard for indoor, dry locations only

3.2 Options

- Variable hand-held controller cable length, up to 1,000 feet from pump
- Alternate motor selections available for outdoor, washdown, chemical duty, and other special applications

4. Safety Considerations

- Read and understand all related instructions and documentation before attempting to install or maintain this equipment
- Observe all special instructions, notes, and cautions.
- Act with care and exercise good common sense and judgment during all installation, adjustment, and maintenance procedures.
- Ensure that all safety rules, work procedures, and standards that are applicable to your company and facility are followed during the installation, maintenance, and operation of this equipment.

4.1 General Safety

The MPC was designed as a controller for operation solely with Pulsafeeder metering pumps. Use for any other application is considered un-safe and voids all certification markings and warranties.

4.2 Electrical Safety

The MPC can be considered an industrial process controller. Improper application and use can be hazardous. You are solely responsible for its use.

The MPC's electrical installation must conform to all relevant electrical codes. Installation and electrical maintenance must be performed by a qualified electrician. Before installing or servicing this device, all power must be disconnected from the source at the main distribution panel.

The MPC emits electro-magnetic energy and may generate radio frequency interference. Its use is restricted to industrial applications. You are responsible for shielding this energy/interference.

Certain wiring procedures may require that the user wear a wrist strap to dissipate static charges.

4.3 Fire Safety

In case of electrical fire, use a Class C fire extinguisher. Never use water to extinguish a Class C fire.

Class C fires involve electrical equipment, such as appliances, wiring, circuit breakers and outlets. Never use water to extinguish class C fires - the risk of electrical shock is far too great! Class C extinguishers do not

have a numerical rating. The C classification means the extinguishing agent is non-conductive. Geometric symbol (blue circle)



Wait a minimum of 3 minutes after disconnecting power before servicing the MPC or pump motor. Capacitors retain a charge even after power is removed from the controller.

4.4 **Mechanical Safety**

Users should note that the pump motor is always under the control of the MPC, and as such may actuate without warning. Care should be taken to keep loose clothing and other objects away from the pump motor.

The MPC was designed to be service free. It contains no user-maintainable components. Disassemble the MPC enclosure only for initial field wiring, or as instructed to do so within this manual. Evidence of unauthorized disassembly shall void the warranty.

4.5 **Hydraulic Safety**



Thoroughly review and adhere to the contents of the pump Installation, Operation, Maintenance and Instruction manual for installation of the Pulsafeeder metering pump. As a microprocessor controlled device, the MPC may activate the pump motor without warning – generating hydraulic pressure and fluid flow. Care should be taken to protect both users and systems should the pump activate.

4.6 **Liability Exclusion**



Pulsafeeder, Inc. is unable to monitor the observance of the instructions given in this manual, nor verify the actual working conditions and installation of the equipment, the correct operation, the using and maintenance of the equipment and accessories. An incorrect installation, or misuse of the equipment, may cause serious damage and may pose a danger to persons or property. Any anomalies must be reported to the maintenance supervisor. The user is not authorized to tamper with the machine for any reason.

Attempts to disassemble, modify or tamper in general by unauthorized personnel will void the guarantee and will release Pulsafeeder, Inc. from any liability for damage caused to persons or property resulting from such actions.

Pulsafeeder, Inc. is considered released from any liability in the following cases:

- **improper installation;**
- **improper use of the equipment by non-professional or inadequately trained operators;**
- **use not in compliance with regulations in the Country of use;**
- **lack of maintenance or improperly performed;**
- **use of non-original spare parts or incorrect parts for the model in question;**
- **total or partial failure to observe the instructions;**
- **exceptional environmental events.**



DO NOT PERFORM ANY WORK ON THE PUMP, MOTOR OR MPC CONTROL UNIT WITH ELECTRICAL POWER CONNECTED TO THE MPC CONTROL UNIT. DO NOT OPERATE MPC UNIT WITH THE COVER REMOVED. DANGER OF ELECTRONIC SHOCK AND MECHANICAL PINCH HAZARD!



INSTALLATION AND REPAIRS SHOULD ONLY BE PERFORMED BY AUTHORIZED PERSONNEL!



FOLLOW ALL SAFETY/ LOCAL LOCK-OUT, TAG-OUT PROCEDURES!

5. Pump Suitability to Site of Installation

Upon equipment receipt, verify that pumps have not received any damage due to transportation and are complete with every eventual accessory. In case anomalies or damages are discovered prior to installation, please contact PULSAFEEDER, INC. Technical Service.

6. Transport and Storage

6.1 Consignment receipt and unpackaging

Immediately after receipt of the equipment it must be checked against the delivery/shipping documents for its completeness and that there has been no damage in transportation.

Check any crate, boxes or wrappings for any accessories or spare parts that may be packed separately with the equipment or attached to side walls of the box or equipment.

Each product has a unique serial number. Check that this number corresponds with that advised and always quotes this number in correspondence as well as when ordering spare parts or further accessories.

Shortages or damage should be reported immediately to the carrier and your Pulsafeeder Representative.

6.2 Handling

Boxes, crates, pallets or cartons may be unloaded using fork lift vehicles or slings dependent on their size and construction.

6.3 Lifting

A crane must be used for all controller/pump sets in excess of 25 kg (55 lb). Fully trained personnel must carry out lifting, in accordance with local regulations.

Slings, ropes and other lifting gear should be positioned where they cannot slip and where a balanced lift is obtained.

6.4 Recycling and end of product life

At the end of the service life of the product or its parts, the relevant materials and parts should be recycled or disposed of using an environmentally acceptable method and local requirements. If the product contains substances that are harmful to the environment, these should be removed and disposed of in accordance with current regulations. This also includes the liquids and/or gases that may be used in the "seal system" or other utilities.

Make sure that hazardous substances are disposed of safely and that the correct personal protective equipment is used. The safety specifications must be in accordance with the current regulations at all times.

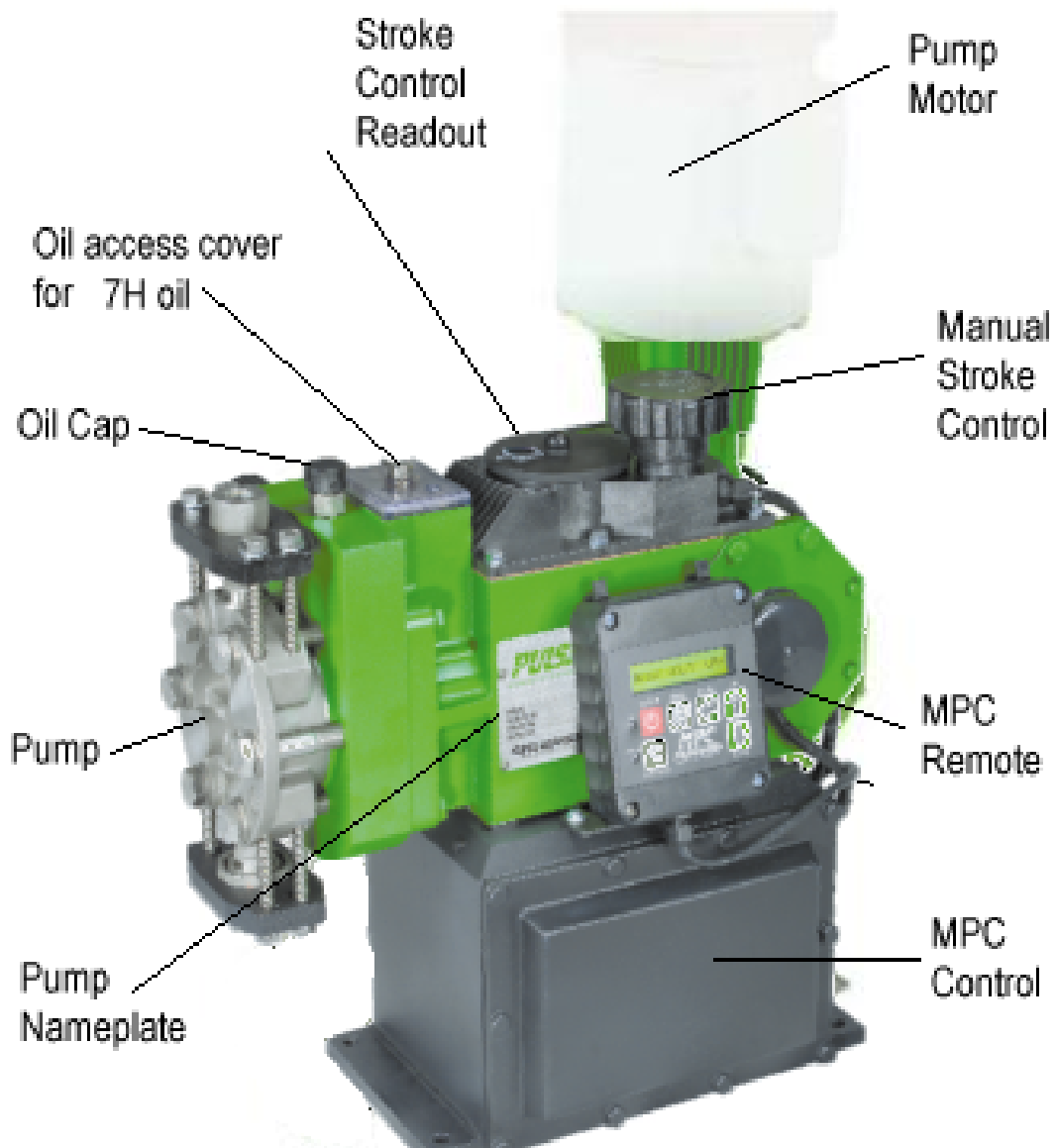

(Pulsar Pump arrangement shown)

7. Storage Instructions

The MPC can be successfully stored for extended periods. The key to this success is temperature and humidity control.

7.1 Short Term (0 - 12 months)

The MPC should be stored in a temperature and humidity controlled environment. It is preferable to keep the temperature constant in the range of -18° to 60° Celsius (0° to 140° Fahrenheit). The relative humidity should be 0 to 90% non-condensing.

If the MPC is installed on the pump, it should not be removed during this period provided the above conditions can be applied to the pump as well.

7.2 Long Term (12 months or more)

Storage of the MPC for periods of longer than twelve months is not recommended. If extended storage is unavoidable the MPC should be stored in accordance with those conditions stipulated for Short Term Storage. In addition, a porous bag of 85g (3 oz) silica gel or similar desiccant should be placed inside the enclosure. The cover should be re-installed to seal the desiccant within the enclosure. The conduit connections must be tightly capped. . Inspect the unit carefully for any signs of damage and remove the desiccant before placing it into operation



Special note for long-term storage:

If AC input power has not been applied to the MPC for a period greater than 12 months, the controller must be prepared for operation. The MPC should have AC power applied at the input for a period of 8 hours before placing pump into normal operation. Refer to Installation and Wiring section for AC power connection instructions.

8. Installation and Wiring

8.1 Location



Review the **Safety** section prior to installing the MPC. It contains information required to properly install and operate the MPC in an industrial environment.

The site selected for the installation of your MPC is largely dependent on that of the metering pump. Review the Installation, Operation, and Maintenance manual provided with your metering pump. It details system related issues that are important to proper operation of the pump. Consider the following MPC related issues when selecting a site. Avoid locations where the MPC would be subjected to extreme cold or heat. The installation of this device must comply with national, state and local codes.

Approximately 6 in (150 mm) of clearance should be maintained around all 4 sides of the MPC.

No special services (e.g. air, liquid cooling) are required. Negligible sound is emitted by the MPC - therefore, no special precautions are necessary.

The MPC controller must be secured to an appropriate support before use. Use four 3/8" (M8) bolts or anchors to secure the MPC controller and pump to a fixed base. No assembly is required for the MPC controller itself.

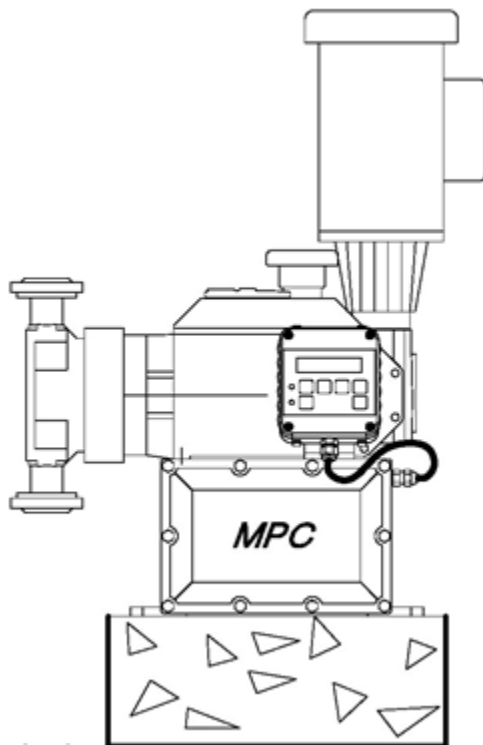

Figure 1 – Typical Installation.



AVOID LOCATIONS WHERE THE MPC WOULD BE SUBJECTED TO EXTREME COLD OR HEAT [LESS THAN 0° CELSIUS (32° FAHRENHEIT) OR GREATER THAN 40 ° CELSIUS (104 ° FAHRENHEIT)] OR DIRECT SUNLIGHT. FAILURE TO OBSERVE THIS WARNING COULD DAMAGE THE MPC AND VOID ITS WARRANTY.

8.2 Installation Notes

The MPC is a microprocessor-based controller that uses electro-static sensitive CMOS components. Do not make any (low or extra-low voltage) electrical connections without adequately grounding the MPC and the worker to eliminate an electro-static charge between the two. **A conductive wrist strap worn by the worker and attached to the MPC enclosure is adequate to satisfy this requirement.**

Conduit connections can carry fluids and vapors into the MPC causing damage and void the warranty. Care should be taken when installing conduit to protect against fluid/vapor entry. If necessary, provide sealed entries or conduit drains near the point of entry. The controller comes equipped with liquid-tight connectors for signal cable entry points. The user must supply the correct connection for the power entry, as per the local codes and requirements. Any cable entrances that are not used should be appropriately sealed against moisture and vapors.



The safety of any system incorporating the MPC is the responsibility of the assembler of the system.

8.3 Installation guidelines for EMC compliance

- 8.3.1 The cover must be installed properly.
- 8.3.2 Shielded cables used for analog inputs and outputs
- 8.3.3 Proper Earth grounding
- 8.3.4 Ensure Power mains are properly filtered for isolation from line transients,
- 8.3.5 Lightning strikes or other electrical noise sources.



Failure to observe the guidelines above may lead to erratic and possibly unsafe operating conditions.

8.4 Electrical Wiring

The MPC has many advanced features that may make wiring the unit appear complicated. Wiring is actually very simple – one high voltage connection is all that is required to take advantage of the majority of the MPC's features.

If you will be mounting your handheld controller in a remote location, refer to the **Section Extending your Hand-Held Controller** at this time.



WARNING

WHILE THE MPC WIRING REQUIREMENTS ARE VERY SIMPLE, ALWAYS KEEP IN MIND THAT ACCESS TO THESE CONNECTORS REQUIRES THE REMOVAL OF THE COVER, AND AS SUCH THIS PROCEDURE SHOULD ONLY BE PERFORMED BY A TRAINED PROFESSIONAL.



WAIT A MINIMUM OF 3 MINUTES AFTER DISCONNECTING POWER BEFORE SERVICING THE MPC OR PUMP MOTOR. CAPACITORS RETAIN A CHARGE EVEN AFTER POWER IS REMOVED FROM THE CONTROLLER.

It is highly recommended that you take a step-by-step approach to wiring and confirming proper MPC operation:

- 8.4.1 Make the high voltage connections (*ref. Section 8.4.7*). These will allow you to operate the MPC and attached Pulsafeeder pump.
- 8.4.2 Decide which low voltage Inputs and Outputs (e.g., 4-20mA in) will be used and make those connections (*ref. Section 8.4.8*).
- 8.4.3 Power-up and test the MPC to confirm the connections and check for proper operation.
- 8.4.4 Configure the software via the menu system for the desired operational conditions. Depending on the anticipated function, users may need to enter settings for the following:
- 8.4.5 Analog input signals, so the MPC can accept a process input signal.
 - i. Analog output settings, so the MPC can provide a process feedback signal.
 - ii. Digital input settings, for example start/stop and/or leak detection inputs.
 - iii. Digital output settings, for example status and/or alarm outputs.
 - iv. Conduct a final power-up and test the MPC to confirm the connections and check for proper operation.
 - v. Go to the **Section 9 – Startup & Operation** for details on how to perform the power-up tests. Controller Layout

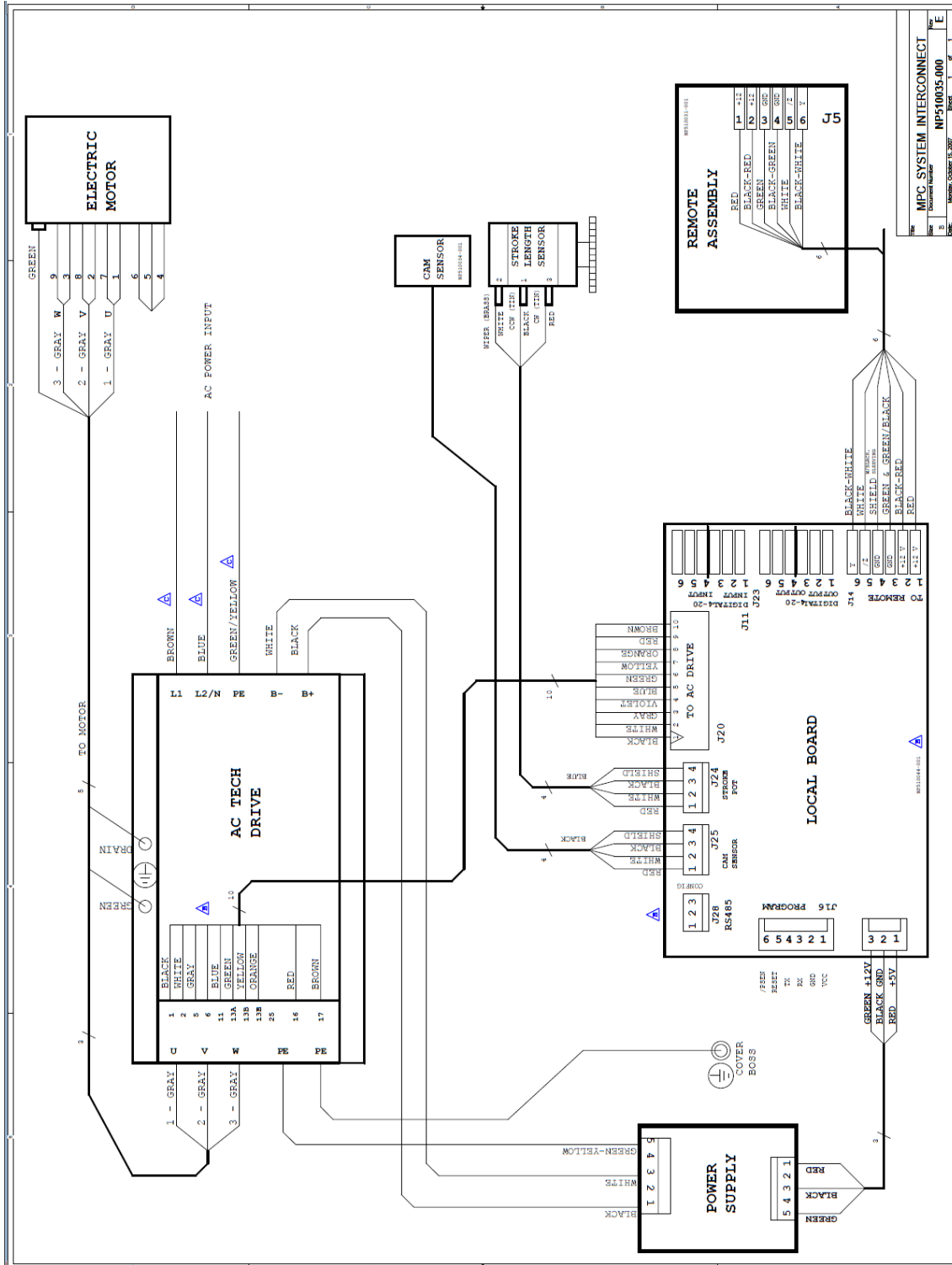

The design of the MPC incorporates all control circuitry onto one easily accessed circuit board. This board is located on the inside of the main controller cover. Gain access to this board by removing the 10 bolts and gently allowing the cover to hinge downwards.



USE CARE NOT TO PULL ON OR ATTEMPT TO COMPLETELY SEPARATE THE COVER FROM THE MPC UNIT, AS THE ELECTRICAL CONNECTIONS MAY BECOME UNPLUGGED AND/OR DAMAGED. THIS CAN RESULT IN IMPROPER OPERATION.

FIGURE 2 – CONDUIT CONNECTION LAYOUT

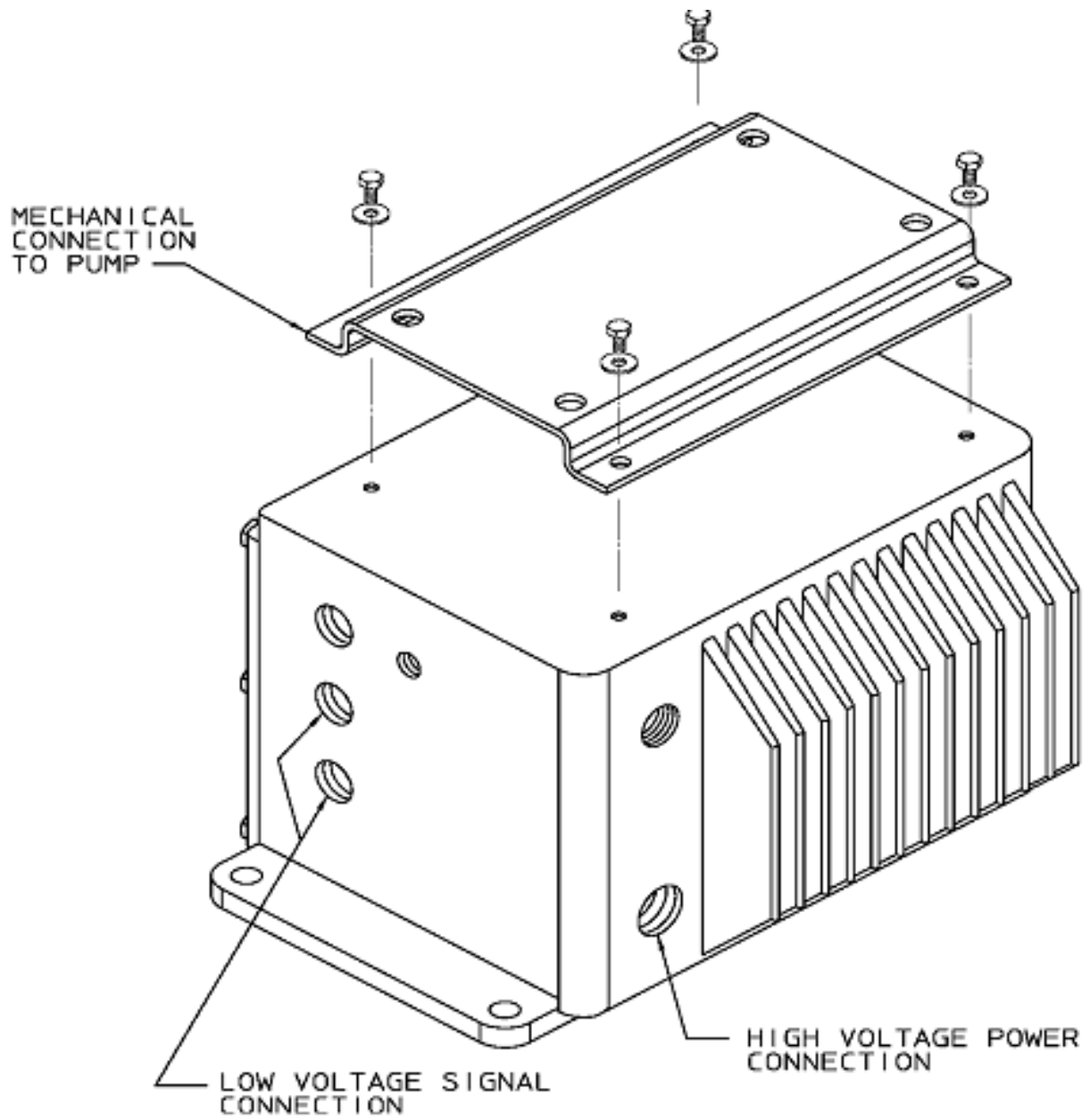

8.4.6 Power Wiring Information



- Verify the correct supply voltage (115VAC or 230VAC) with the nameplate affixed to your MPC. Ensure that your supply voltage matches the MPC configuration.



- Wires should be routed within the enclosure in a manner that maintains separation between low voltage and extra-low voltage conductors.



- Applicable national and local electrical codes take precedence over recommendations in the table below.



- A circuit breaker or fuse must be provided as noted below.



- Upon initial application of AC power, a current inrush will occur to charge the DC bus capacitors. This is normal operation, and breakers and other circuit protection devices should be sized accordingly.

Power Requirements	Recommended Minimum Wiring and Circuit Breaker									
	115 VAC Operation					230 VAC Operation				
	Actual Draw	Circuit Breaker	Wire Size	Wire Size	Safety Approvals ¹	Actual Draw	Circuit Breaker	Wire Size	Wire Size	Safety Approvals ¹
MPC and 0.25 Hp motor	7.0 A	10 A	14 AWG	2.5 mm ²	UL, CUL, CE	3.5 A	10 A	14 AWG	2.5 mm ²	UL, CUL, CE
MPC and 0.33 Hp motor	7.0 A	10 A	14 AWG	2.5 mm ²	UL, CUL, CE	3.5 A	10 A	14 AWG	2.5 mm ²	UL, CUL, CE
MPC and 0.5 Hp motor	9.4 A	15 A	14 AWG	2.5 mm ²	UL, CUL, CE	5.2 A	10 A	14 AWG	2.5 mm ²	UL, CUL, CE
MPC and 0.75 Hp motor	16.8 A	25 A	12 AWG	4.0 mm ²	UL, CUL	9.4 A	15 A	14 AWG	2.5 mm ²	UL, CUL
MPC and 1.0 Hp motor	16.8 A	25 A	12 AWG	4.0 mm ²	UL, CUL	9.4 A	15 A	14 AWG	2.5 mm ²	UL, CUL
MPC and 1.5 Hp motor	24.2 A	35 A	10 AWG	6.0 mm ²	UL, CUL	12.2 A	20 A	14 AWG	2.5 mm ²	UL, CUL

Table 1 – Sizing Branch Circuits

Note 1: Applicable standards are Cenelec EN61326-1, UL61010-1, and CSA C22.2#61010-1 and EN61010-1 3rd edition.

The MPC requires one connection to an external power source. It uses this same connection to power its own supply, as well as the AC pump motor. You must take all of these loads into consideration when sizing

the branch circuit (**see Table 1**). A circuit breaker or disconnect switch with fuses must be wired in series with terminals L1 and L2/N in accordance with all applicable local and national electrical codes and regulations. The circuit breaker or disconnect switch shall be located in close proximity to the MPC controller. It must be positioned such that it is not difficult to operate and must be marked or labeled to identify it as the power disconnect for the MPC.

The MPC controller is provided with a ¾ inch NPT inlet for incoming AC power wiring at the rear (pump gearbox end) of the enclosure. Utilize the appropriate conduit fittings to route and seal the supply wires into the MPC enclosure.

These wires are secured to the terminal strip at the right-hand end of the AC drive as per **Table 2 and Figure 3**. Remove approximately 0.20 – 0.25 inches, (6mm) of insulation from the end of each conductor. Loosen the terminal strip screw, and insert the stripped wire end fully into the terminal. Tighten the screw to 4.5 in-lbs. (0.5 Nm) to secure the conductor. Make certain that the terminal grips the wire, not the insulation. Ensure that all wiring meets applicable local and national codes and requirements.

8.4.7 Power Wiring Diagram

MPC Drive Terminal	115 V Operation	230 V Operation
L1	Line	Line
L2 / N	Neutral	Line/Neutral
Earth	Ground	Ground

Table 2 – AC Drive Terminals



Note: Power wiring should have a rating of at least 300 volts AC (rms) and a temperature rating of at least 105 Degrees C.

A circuit breaker or disconnect switch with fuses, must be provided in accordance with all applicable local and national electrical codes and regulations. Size external fusing/breaker for ratings for the wiring used for the unit.



Applicable national and local electrical codes take precedence over recommendations made here.



To ensure proper operation, the MPC should remain powered at all times. A dry contact input provides the MPC with motor status (on vs. off). See *Section 13 (Digital In #1 & Digital In #2)*



Input Power must be run in separate conduit. Do not combine Power and Control wires in a common conduit!



Field Wiring conductors shall be copper conductors only!

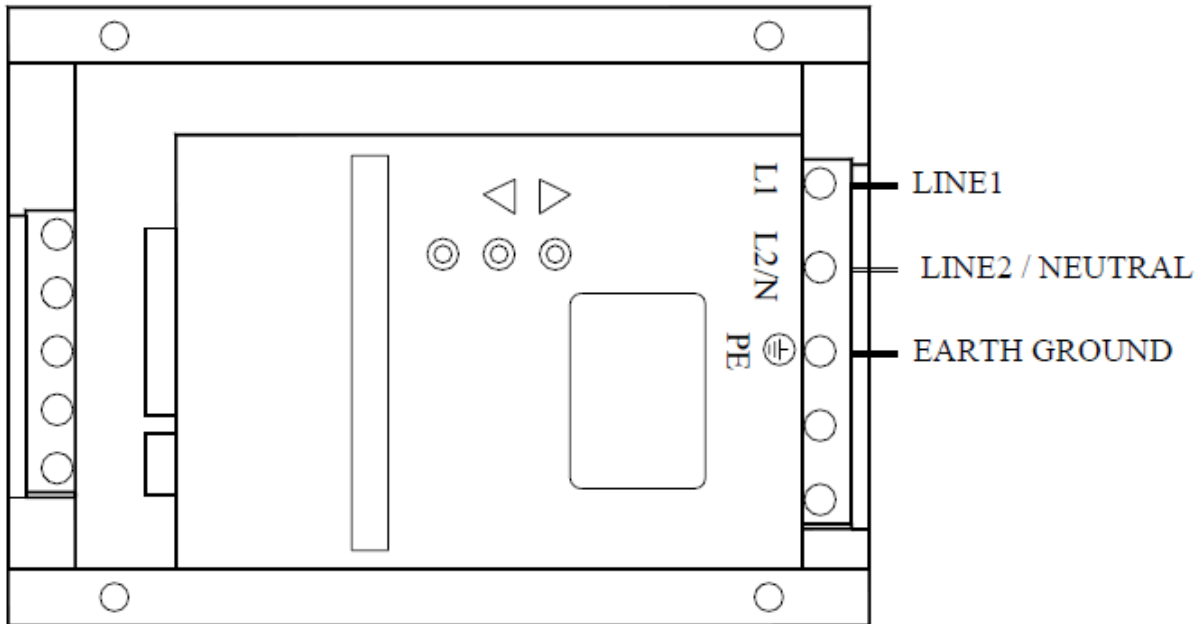
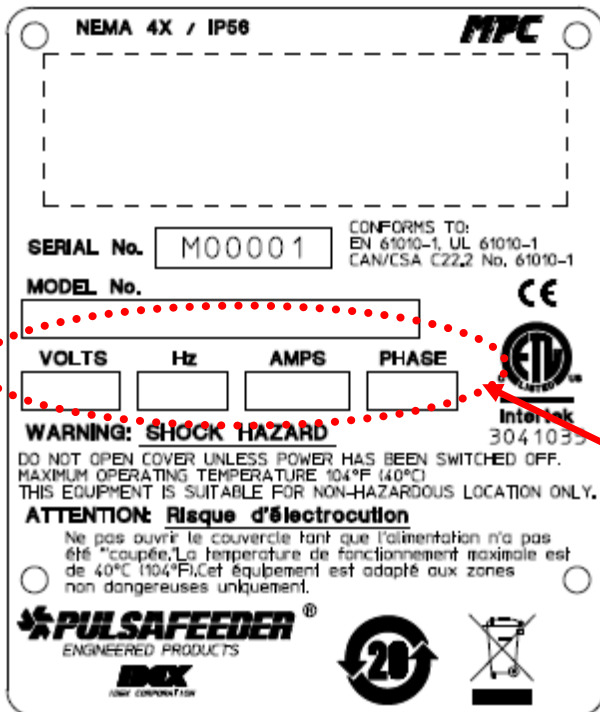

Figure 3 – AC Drive Power Connections



Wait a minimum of 3 minutes after disconnecting power before servicing the MPC or pump motor. Capacitors retain a charge even after power is removed from the controller.



Find the proper AC input voltage for your MPC controller on the nameplate at the rear of the unit. MPC input is always single phase, and can be either 115 VAC or 230 VAC, determined at time of order.

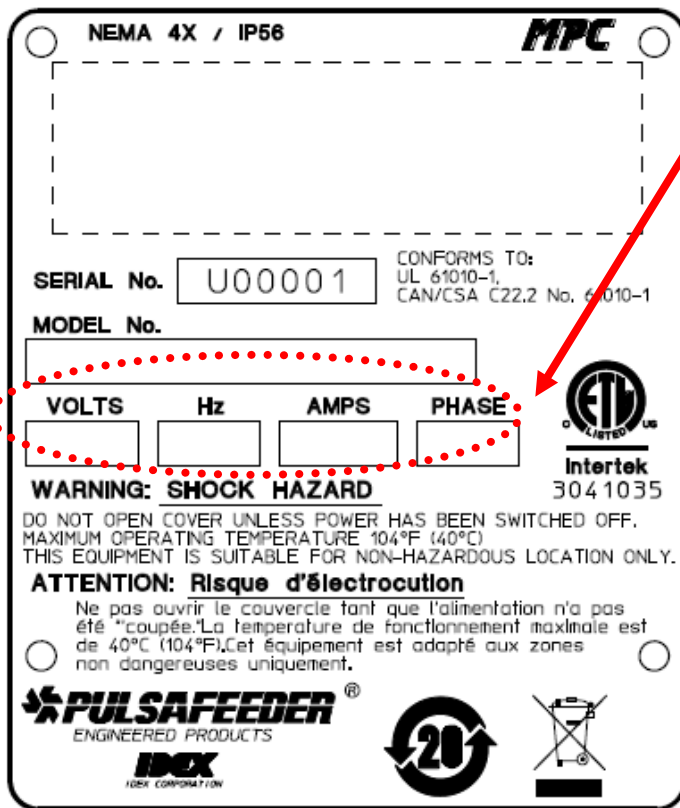

8.4.8 Control Input/Output Signal Wiring

Signal wiring is routed through the two unused conduit openings at the side of the MPC. All input/output signals are connected to the terminal strips at the edge of the MPC circuit board. Use caution to observe proper wire location and signal polarity. Always cap or plug unused openings. Wires should be routed within the enclosure in a manner that maintains separation between low voltage and extra-low voltage conductors. Ensure all low voltage wiring is installed as per any applicable local and national electrical codes and regulations.

Utilize 20 or 22 AWG, 250 V, shielded cable, with a 105° C insulation rating (or better) for all signal input and output wiring. Recommended strip length is 0.39 inches or 10 mm. Refer to *Figure 4* below for signal connection locations.



NOTE

UNUSED CONDUIT OPENINGS SHOULD BE PLUGGED AS REQUIRED TO AVOID INGRESS OF MOISTURE AND CONTAMINANTS INTO THE MPC ENCLOSURE. Do NOT REMOVE THE FACTORY PROVIDED PLUG FROM OPENINGS THAT ARE NOT REQUIRED FOR FIELD WIRING.



WARNING

IT IS RECOMMENDED THAT A WRIST STRAP BE WORN WHEN MAKING CONNECTIONS TO ANY PRINTED CIRCUIT BOARD.

Figure 4 – Signal Connections

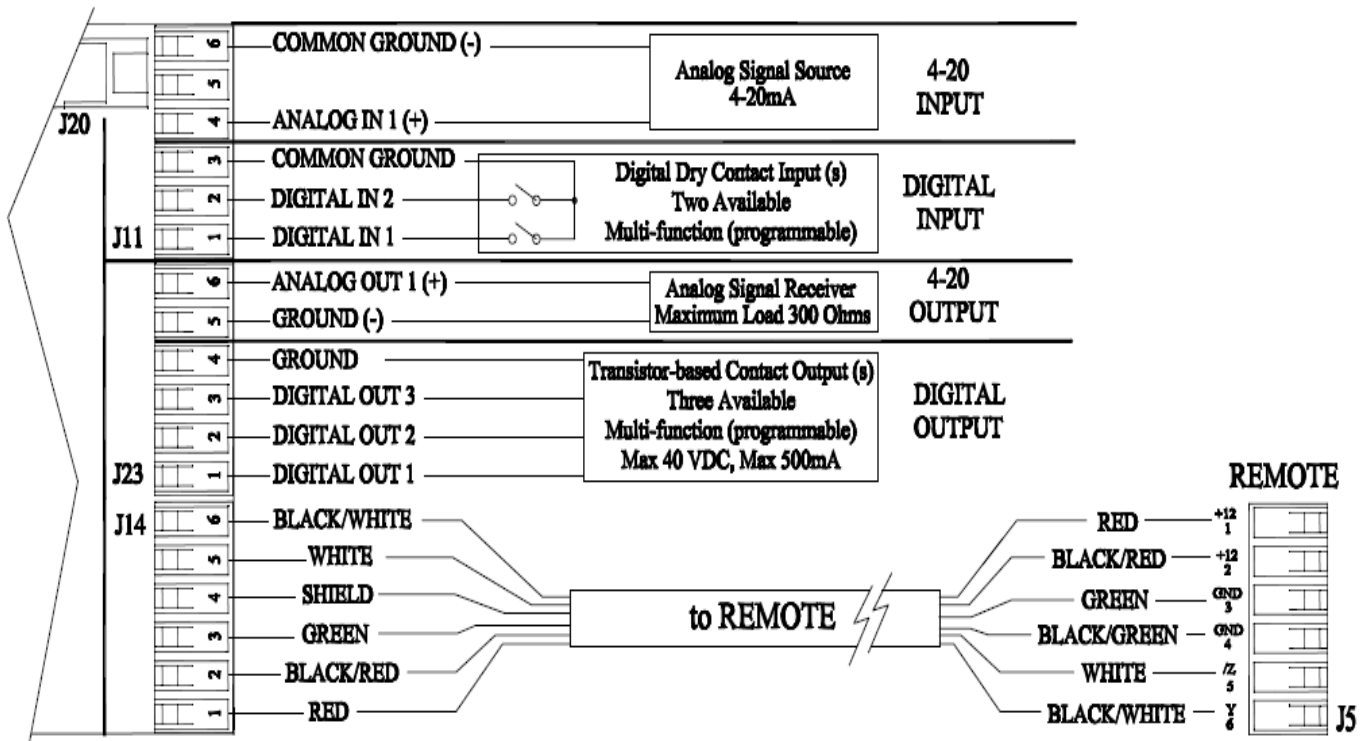

Digital output signals can drive devices such as relays or indicator lamps. 24 VDC power must be supplied from an external source. Each output has a maximum current capability of 500 mA. Maximum voltage capability of these circuits is 40 VDC (see the **Specifications Section**, for more information).

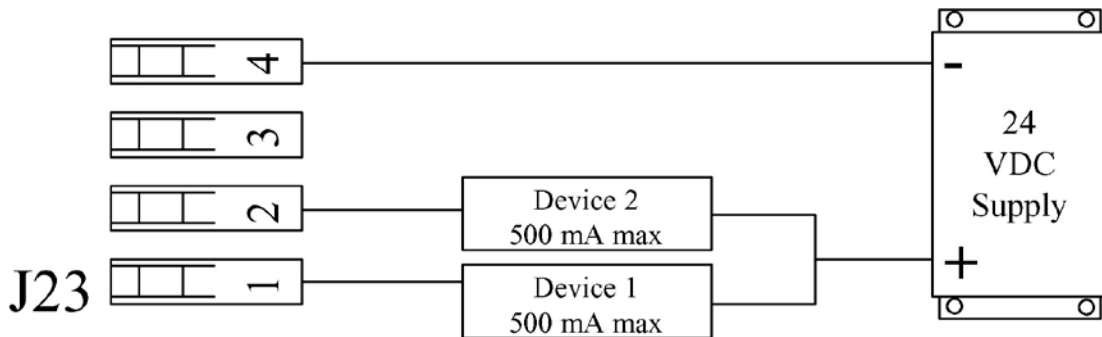

Figure 5 – Sample Digital Output Connections

8.5 Check Wiring and Close Access Cover

Double-check all of your electrical connections. Pay attention to polarity of all inputs and outputs – both low and extra-low voltage. Additionally, insure that all terminals are clamping onto the bare conductor, not on its insulation. Ensure that wires will not be trapped or pinched when front cover is replaced and secured. Ensure that excess insulation is not removed from the wires, as this can lead to poor connections or faulty operation.

Replace the main access cover and secure the 10 bolts.



Use a nut driver to tighten the retaining bolts evenly to 35 in-lbs (4.0 Nm). Failure to do so may cause the cover to leak and void the warranty.

8.6 Confirm Correct Incoming Power



WITHOUT PRIOR OPERATING KNOWLEDGE, IT IS IMPOSSIBLE TO TELL IF THE PUMP MOTOR WILL RUN WHEN POWER IS APPLIED TO THE MPC. YOU ARE RESPONSIBLE FOR TAKING THE NECESSARY STEPS TO ENSURE THAT ALL ASPECTS OF SAFETY HAVE BEEN CONSIDERED (E.G., ELECTRICAL, HYDRAULIC, ETC.).

Clear all lockout tag out controls. Turn on power at the mains or distribution panel. If the MPC's incoming power is connected correctly, the backlighting on the MPC's display will illuminate (depending on lighting conditions, it may be necessary to shade the display to confirm illumination). If the display is not illuminated, first check the line voltage

with a voltmeter. If the voltage is not correct, return to **5.3.2 - Power Wiring Information**. Otherwise, proceed with the next step.

9. Start Up and Operation

9.1 Overview

Once all electrical connections have been made, your MPC is ready for Start-up. The following sections detail the procedures required to complete the MPC start up.



WARNING: DO NOT attempt to remove the cover of the MPC and set up the MPC in a very wet or rainy environment. While care has been taken to insulate power connections, DANGEROUS voltages are present and can cause electric shock, and possible electrocution if safety procedures are not followed



WHEN POWER IS SUPPLIED TO THE UNIT, LINE VOLTAGE IS PRESENT WITHIN THE MPC ENCLOSURE EVEN WHEN THE MOTOR IS OFF.



DURING START-UP, IT IS NECESSARY TO RUN THE PUMP MOTOR. THIS WILL CAUSE FLUID TO DISCHARGE FROM THE PUMP. YOU ARE RESPONSIBLE FOR SAFELY DIVERTING FLOW FROM THE PUMP DURING START-UP AND CALIBRATION.



THE MPC IS DESIGNED TO RUN THE PUMP CONTINUOUSLY WITHIN ITS RATED PRESSURE AND FLOW. OPERATION BEYOND RATED SPECIFICATIONS, EVEN INTERMITTENTLY, MAY DAMAGE EQUIPMENT AND VOID THE WARRANTY.

IF THIS EQUIPMENT IS USED IN ANY MANNER NOT SPECIFIED BY PULSAFEEDER, PROTECTION PROVIDED BY THE EQUIPMENT MAY BE IMPAIRED.

9.2 Keypad/Lamp Operation







Key	Function	Description
	Motor On/Off	Press to start pump motor, press again to stop pump motor
	Auto/Manual	Press to toggle between automatic operation and manual control of the pump
	Menu	Press to adjust controller settings, to exit the menu system, to move cursor back when entering values, or to step back to higher level menus
	Enter	Press to accept changes in menus, to move cursor forward when entering values, and to access lower level menus. Also used to toggle between pump output display options while in operating mode (% flow, spm, gph, etc.)
	Arrow Up	Press to adjust values upwards, and to scroll through menu options
	Arrow Down	Press to adjust values downwards, and to scroll through menu options
Lamp	Color	Description
ON 	Green, Amber, Red, Off	Off = Motor off Green = Motor on Amber = Remote standby Red (blinking) = Error
MANUAL 	Green, Off	Green = Manual Control Off = Automatic Control

Table 3 – Keypad and Lamp Operation

9.3 Confirm Display and Keypad Functionality

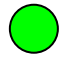
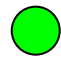

The example display messages are shown in English for demonstration purposes. If an alternate language has been set, the text is displayed as a translation of the English version.

Now that you have confirmed that the MPC is receiving power, it is necessary to confirm that the display and keypad are functioning properly. On normal power-up, the display appears for approximately 2 seconds.

PULSAFEEDER INC.
FW: 00.00/00.00

The first four digits displayed are the software revision for the MPC base unit, and the second four indicate the software revision for the handheld display/keypad module.

The keypad can be tested by depressing each key separately. Most, but not all keys will cause the text on the display to change. Do not be alarmed if a single key does not invoke a change to the display. This is normal. Different keys become active/inactive depending on the current operating mode.

Please note that it may be necessary to adjust the display contrast; please refer to **Section 10.8** if this is required.

9.4 Flow Display

The MPC will display calibrated pump flow in GPH or LPH on the digital display. The MPC is capable of very high turndown ratios, limited only by pump configuration and system design. In some cases, the MPC display will be unable to display very low flow rates, in these situations the display may indicate 0.0 for flow, even though the pump is producing measurable flow. If the pump is being operated under these conditions, users may wish to perform extra flow calibrations to verify actual flow rates at certain set points. Note that even after the additional calibrations are done, the MPC will still not display the low flow that the pump is producing.

In situations where the pump stroke length is set to 0 (zero) %, the pump will also display 0 (zero) GPH or 0 (zero) LPH, regardless of motor speed setting. If the display registers no flow in this manner, check the setting of the stroke length mechanism on your pump.

9.5 Wrapping up

Your MPC is now commissioned for use. Note that you cannot configure the software in a way that would damage the MPC. Typically, whenever you are about to set a critical value (e.g., Calibrate Flow), you are always prompted to confirm your change before it takes effect. If you are ever dissatisfied with the configuration of your MPC, you can always return to the Factory Defaults by referring the next section.



Factory Re-initialization is typically not required. When re-initializing your MPC, all of the system settings and calibration information will be overwritten by the original factory default settings. The controller must be re-configured and re-calibrated to your specifications.

A Factory Re-initialization should be performed only if there is reason to believe that the internal MPC memory has become corrupted. The condition usually manifests itself with inconsistent or erratic operation – often associated with meaningless characters on the display, or exaggerated numerical values.

Factory Re-Initialization:

1. Press the MENU key to access the System Setup Menu

-MENU-
CALIBRATION

2. Press the UP arrow key to display

-MENU-
SYSTEM SETUP

3. Press the ENTER key

SYSTEM SETUP
SECURITY

4. Press the UP arrow key twice to display

SYSTEM SETUP
FACTORY INIT

5. Press the ENTER key

PRESS ENTER
TO FACTORY INIT

6. Press the ENTER key

ARE YOU SURE?
YES=ENTER NO=MENU

7. Press the ENTER key

RESETTING PUMP
TO FACTORY INIT

10. Input/Output Setup

Use the “DIGITAL I/O” menu to activate the functions required for the intended application.

Users may also reference **Section 14 – Menu Maps** for additional configuration assistance

10.1 Analog Input Setup

Use the “ANALOG I/O” menu to activate the analog input signal function.

The menu can be used to set the analog input to either ACTIVE or INACTIVE.

10.2 Digital Input Setup

Each of the 2 Digital INPUTS can be selected as:

- Inactive
- Leak Detection
- Tank Level Input
- Remote ON/OFF Input
- Flow Detection (delay time must be set)

Each can be set as normally OPEN or normally CLOSED. For example, if an input is set to ON/OFF and NORMALLY CLOSED, this means a CLOSED switch will activate the pump. A NORMALLY OPEN setup will give the opposite response.

10.3 Analog Output Setup

Use the “ANALOG I/O” menu to activate the analog output signal function.

The menu can be used to set the analog output to either ACTIVE or INACTIVE.

10.4 Digital Output Setup

Each of the 3 Digital OUTPUTS can be selected as:

- Inactive
- ON/OFF Status
- AUTO/MAN Status
- Stroke Indicator (Pulse Output)
- Alarm Indicator
- Leak Detection Status
- Tank Level Status

Each can be set as normally OPEN or normally CLOSED. For example, if an output is set to ON/OFF INDICATION and NORMALLY CLOSED, this means that when the motor is running (indicator lamp is ON) the output will be CLOSED. A NORMALLY OPEN setup will give the opposite response.

Digital output circuits are transistor based and limited to 40 VDC maximum, see **Section 8.4.8 - Control Input/Output Signal Wiring**, and **Specifications Section**, for more information.

10.5 Pump Flow Calibration

Your MPC is factory calibrated at rated flow and pressure. Nevertheless, you should always perform a calibration with the MPC installed in your system. This will provide the most accurate flow display.

The only item required to calibrate your MPC is a means to measure the flow of the pump (i.e., calibration column, graduated cylinder, etc.). The most accurate calibration will be obtained by using a measurement device installed on the suction side of the pump. Note that calibration values for liquid volume will be in the user's chosen units, either gallons or liters.

There are two methods for completing the flow calibration routine, either "Volume" or "Flow".

Volume Method Calibration

The volume calibration is accomplished by running the pump at two different stroke length settings, 50% and 100%. During each run a volume of liquid will be pumped from the calibration column. This volume is then entered into the MPC for calibration. Note that for this calibration, the actual volume of liquid pumped is entered in gallons or liters. Do not enter a flow rate in gallons or liters per hour, as this will not result in a valid calibration. The MPC display will guide the user through the steps for calibration.

Please note that it must be safe to run the pump and dispense liquid into the system in order to complete this calibration. The pump should be fully primed with the product in order to complete an accurate calibration. Hydraulic diaphragm pumps must have a proper hydraulic prime as well.

10.5.1 Flow Method Calibration

The flow calibration is accomplished by entering values for flow that are already known to the user. The MPC will request flow values in gallons or liters per hour for each of the two calibration points, 50% and 100% stroke length. This calibration is useful if operational circumstances do not permit

the pump to run for calibration. This calibration is also faster to complete if the flow values are already known. The MPC display will guide the user through the steps for calibration.

The nameplate flow rating of the pump can be used to complete the flow calibration routine; however there will always be some variance in the actual flow rate of a pump due to system conditions and product characteristics. Using the pump's nameplate rating will establish a baseline flow rate on the MPC display; however it will not guarantee absolute accuracy.

To Start Calibration

1. The starting display will be:

```
SETPT      XX.XXX
FLOW       XX.XXX
```

2. Press the MENU key

```
-MENU-
CALIBRATION
```

3. Press the ENTER key

```
CALIBRATION
PUMP FLOW
```

4. Press the ENTER key

```
CALIBRATION
"VOLUME"
```

5. To perform the Volume Method, press the ENTER key and go to the next **Section –Voume Method**

6. To perform the Flow Method, press the UP arrow key

```
CALIBRATION
"FLOW"
```

7. Press the ENTER key and go to the Flow Method **Section 10.5.2**

If you receive the following message during the Volume calibration:

```
STROKE LENGTH OUT
OF RANGE
```

Verify that the manually set stroke length is at the correct position, either 50% or 100%.

Volume Method

SET STROKE TO 50%
ENTER TO START

1. Manually adjust the stroke length of the pump to 50%
2. ** Fill your calibration column to the zero or starting point
3. Press the ENTER key

TIMER XX SEC
ENTER TO STOP

4. Allow the pump to run for any length of time you choose, dependent on flow rate, calibration column size, process conditions, etc. The system will time out at a maximum of 300 seconds.
5. Press the ENTER key to stop the pump

ENTER VOLUME
VOL = XX.XXX

6. Use the UP and DOWN arrow keys and the ENTER key to input the volume pumped from the calibration column (in gallons or liters, dependent on MPC setup).
7. Press ENTER to proceed

SET STROKE TO 100%
ENTER TO START

8. Manually adjust the stroke length of the pump to 100%
9. ** Fill your calibration column to the zero or starting point
10. Press the ENTER key

TIMER XX SEC
ENTER TO STOP

11. Allow the pump to run for any length of time you choose, dependent on flow rate, calibration column size, process conditions, etc. The system will time out at a maximum of 300 seconds.
12. Press the ENTER key to stop the pump

ENTER VOLUME
VOL = XX.XXX

13. Use the UP and DOWN arrow keys and the ENTER key to input the volume pumped from the calibration column (in gallons or liters, dependent on MPC setup).
14. Press ENTER to proceed

PUMP FLOW
CALIBRATED

15. Pump flow calibration is complete
16. Press the MENU key three times to exit back to the main operating screen.

10.5.2 Flow Method

SET STROKE 50%
FLOW = 0.0000 GPH

1. You do not have to adjust the actual stroke setting of the pump
2. Use the UP and DOWN arrow keys and the ENTER key to input the desired flow rate (in gallons or liters per hour, dependent on MPC setup). This should be the flow rate expected when the pump is set to 50% stroke length setting.
3. Press ENTER to proceed

SET STROKE 100%
FLOW = 000.00 GPH

4. You do not have to adjust the actual stroke setting of the pump
5. Use the UP and DOWN arrow keys and the ENTER key to input the desired flow rate (in gallons or liters per hour, dependent on MPC setup). This should be the flow rate expected when the pump is set to 100% stroke length setting.
6. Press ENTER to proceed

PUMP FLOW
CALIBRATED

7. Pump flow calibration is complete
8. Press the MENU key three times to exit back to the main operating screen.

10.6 Analog Input Calibration

If you are not using the 4-20mA input to the MPC for control, skip this section. To calibrate the Input Current you must first correctly wire an external signal source. Refer to *the **Control Input/Output Signal Wiring Section (8.4.8)***. To perform a calibration, the signal-generating device must be active and capable of generating the full range (low to high) of potential input signals.

1. The starting display will be:

```
SETPT      XX.XXX
FLOW       XX.XXX
```

2. Press the MENU key

```
-MENU-
CALIBRATION
```

3. Press the ENTER key

```
CALIBRATION
PUMP FLOW
```

4. Press the UP arrow key twice, to access the analog input calibration

```
CALIBRATION
ANALOG INPUT
```

5. Press the ENTER key

```
APPLY MIN MA
ENTER TO START
```

6. Apply your desired minimum mA control signal to the MPC (usually 4 mA)

7. Press the ENTER key

```
MIN SETPT  X.XX MA
SPEED      000.0%
```

(The mA value will be equal to your input signal level)
(The speed value is the setting the MPC will use for this signal value)

8. Press the ENTER key three times to step through the speed setting value, most users will leave this at 000.0 %, however you can change it if you wish using the UP and DOWN arrows.
9. Press the ENTER key once more to accept the calibration value

APPLY MAX MA
ENTER TO START

10. Apply your desired maximum mA control signal to the MPC (usually 20 mA)

11. Press the ENTER key

MAX SETPT X.XX MA
SPEED 100.0%

(The mA value will be equal to your input signal level)
(The speed value is the setting the MPC will use for this signal value)

12. Press the ENTER key three times to step through the speed setting value, most users will leave this at 100.0 %, however you can change it if you wish using the UP and DOWN arrows.

13. Press the ENTER key once more to accept the calibration value

ANALOG INPUT
CALIBRATED

14. Analog input signal calibration is complete

15. Press the MENU key three times to exit back to the main operating screen.

If you receive the following message:

CURRENT DELTA
OUT OF RANGE

This indicates that there is not a wide enough range between your maximum and minimum analog signals. The minimum signal range is 3 mA. The most likely source of this error is the user did not change the value of the incoming analog signal when moving from the MIN calibration to the MAX calibration.

The analog input signal calibration procedure should be performed again, ensuring that a minimum of 3 mA difference exists between the MIN and MAX signal levels.

10.7. Analog Output Calibration

1. The starting display will be:

```
SETPT      XX.XXX  
FLOW      XX.XXX
```

2. Press the MENU key

```
-MENU-  
CALIBRATION
```

3. Press the ENTER key

```
CALIBRATION  
PUMP FLOW
```

4. Press the UP ARROW key to access the analog output calibration

```
CALIBRATED  
ANALOG OUTPUT
```

5. Press the ENTER key

```
SET 0% FLOW TO  
04.0 MA
```

6. Use the UP and DOWN arrow keys to adjust the output signal as required. The actual output signal will vary and can be monitored with a meter or your facility control system. The value displayed on the screen may not match the actual output signal and is for visual reference only.

7. Press the ENTER key once more to accept the calibration

```
SET 100% FLOW TO  
20.0 MA
```

8. Use the UP and DOWN arrow keys to adjust as in step 6 above
9. Press the ENTER key once more to accept the calibration value

```
CALBRATION  
ANALOG OUTPUT
```

10. Analog output signal calibration is complete
11. Press the MENU key three times to exit back to the main operating screen

If you receive the following message:

CURRENT DELTA OUT OF RANGE

This indicates that the output current for 0% flow has been set greater than or equal to the output current setting for 100% flow. Repeat the process and ensure that the 0% calibrated signal is set to a value lower than the 100% calibrated signal.

10.8 Display Contrast Adjustment

Should adjustment of the contrast level of the display become necessary, use the following procedure while in the normal operating mode.

To increase contrast, press   and hold at the same time.

To decrease contrast, press   and hold at the same time.

10.9 Changing the Motor Base Frequency

This procedure will not be necessary during normal operation of the MPC controller. In the event that you need to install a different drive motor, and that motor has a different base frequency (50 Hz vs. 60 Hz) than the original unit, please refer to this procedure. These changes are made at the AC drive within the MPC enclosure and not at the hand-held unit.



This procedure is performed with power applied to the MPC. Take ALL NECESSARY precautions, keep fingers and tools clear of energized circuits, and perform this procedure only if you are certain it is required.

1. Open the front cover of the MPC control
2. There are three buttons on the face of the drive, **MODE**, **UP** and **DOWN**.
3. Press the **MODE** button

4. Scroll **UP** to display the default password “001”
5. Press **MODE** to enter the password
6. Scroll **UP** to the base frequency parameter which is “27” display will show “P 27”
7. Press **MODE** to display the current setting (will be either 50 or 60)
8. Use the **UP** or **DOWN** keys to change the setting to the new value (either 50 or 60)
9. Press **MODE** to store the new value
10. Drive will exit the program mode after it stores the new value

This procedure should be used only if the base frequency of the pump drive motor is changed.

11. Alarm and Error Messages

If a fatal error has occurred while in Operational Mode, the error will flash on the screen and the Red LED lamp will also flash. The menus can still be accessed by holding down the menu key. This allows the user to try and fix the source of the error if possible.

The following table gives an example of these messages and when you can expect them to be displayed.

Message	Displayed When:
FATAL ERRORS: The pump and controller will not run while one of these error conditions exists. The Red LED will blink and the error message will flash on the screen. Users can access the menu system by pressing the MENU key. The red LED and the message will cease when the error condition has been corrected.	
Analog Input #X Out of Range	The analog input is less than 2.4 mA or greater than 24 mA
ALARM LEAK DETECT	The leak detection input has triggered
ALARM LOW LEVEL	The level monitoring input has triggered
ALARM AC DRIVE FAULT	Internal fault
ALARM Motor error	The MPC has detected that the motor shaft is not rotating at the expected speed
ALARM CAM SENSOR	MPC controller is not receiving correct signals from the cam sensor in the pump eccentric box

COMMUNICATION ERROR	Communication error exists between the MPC controller and the handheld keypad/display module
NON-FATAL ERRORS: The pump and controller can still be run while these conditions exist. The Red LED will flash, however no message will flash on the screen. The Red LED will stop flashing once the error condition has been corrected.	
ALARM STROKE SENSOR	MPC does not receive valid indication from the stroke position sensor, the flow display will not be accurate
SOFTWARE Fault Error = ####	Software related problem, record error number and consult factory
Hardware fault Error = ####	Hardware related problem, record error number and consult factory
CONSULT factory Error = ####	Unidentified error, record error number and consult factory
USER NOTIFICATIONS: These are errors in setup or calibration. They will display on the screen for several seconds. They can be corrected by properly completing the procedure involved.	
Cannot access With motor on	User is trying to change a setting that cannot be changed while the pump is running
Stroke length Out of range	Stroke length position is not set correctly for current operation
Current delta Out of range	Not enough difference between high and low signals during an analog input signal calibration (min 3 mA)
Stroke delta Out of range	Stroke length position is not set correctly for current operation
No remote Control	User is trying to activate the AUTO mode, but there is no remote input (mA signal or remote on/off) to the controller



For unlisted or numbered error codes, consult the factory for assistance. Pressing MENU will clear all non-fatal errors, provided the error condition is no longer present.

12. Extending your Hand-Held Controller

The hand-held controller for your MPC can be placed as far as 1000 feet from the pump with optional cable. It is recommended that all calibrations be completed before the cable is lengthened, as these tasks are easier when the pump and hand-held controller are close to each other.

To replace the cable for the hand-held unit:



POWER TO THE UNIT MUST BE OFF! A GROUNDING WRIST STRAP SHOULD BE WORN WHEN MAKING CONNECTIONS TO ANY PCB

12.1 Obtain New Cable:



The following standard length cables are available from Pulsafeeder for use with the MPC:

Cable Length	Part Number	Notes
6 feet	NP530130-000	Standard, supplied with all MPC controllers
Others per foot	NP530147-000 (1 ft)	NOTE: do not exceed 1,000 feet total length

12.2 Removal and Connection of the Cable from the Handheld:

1. Open the handheld unit by removing the 4 screws on the face of the unit.
2. Open the unit by separating the cover from the base.
3. Disconnect the keypad from the Remote PCB by gently removing the connector at the end of the keypad's tail from the header on the PCB.
4. Make a note of what color lead is in each position of the terminal block "J5". Cut the tie-wrap that secures the cable. Loosen each of the 6 positions on the terminal block "J5" and remove each lead.
5. Loosen the outer domed nut on the liquid tight, releasing the tension on the cable. Pull the cable through the liquid tight. Thread the new cable through the liquid tight with enough length to reconnect to the terminal block.
6. Cut the shield wire as close as possible to the outer insulation at the remote end **only**.

7. Wrap the end of the cable with electrical tape to insulate any remaining shield so that it will not contact the circuit board, equipment case, or any other parts.
8. Referring to the notes taken earlier, connect each lead of the new cable to the proper position of the terminal block; tighten the screw terminal to hold lead. NOTE: It is recommended that you insert and secure one lead at a time.
9. Tighten the dome nut of the liquid tight to secure/seal cable.
10. Replace cover and tighten screws. Be sure the o-ring is in its groove, paying special attention to the corners. NOTE: Do not over tighten.



Wait a minimum of 3 minutes after disconnecting power before servicing the MPC or pump motor. Capacitors retain a charge even after power is removed from the controller.

1. Remove the 10 screws that are securing the cover to the side of the main unit.
2. CAUTION: The cover is wired and should be folded down gently being sure not to pull any of the wires that are connected to it.
3. Make a note of what color lead is in each position of the terminal block "J14". Loosen each position of terminal block "J14" and remove each lead.
4. Loosen the outer domed nut on the liquid tight, releasing the tension on the cable. Pull the cable through the liquid tight. Thread the new cable through the liquid tight with enough length to reconnect to the terminal block.
5. Prepare the end of the cable as per *figure 5b* on the following page. Ensure that the shield is fully insulated until the point where it enters the terminal. No part of the shield should be allowed to come in contact with the circuit board, equipment case, or any other surface.
6. Note that the black-green lead is not utilized at this end of the cable.
7. Referring to the notes taken earlier, connect each lead of the new cable to the proper position of the terminal block, and tighten the screw terminal to hold the lead. NOTE: It is recommended that you insert and secure one lead at a time.
8. Tighten the dome nut of the liquid tight to secure/seal cable.
9. Replace cover carefully being sure not to crimp any of the cables/leads between cover and enclosure and tighten screws.

Power the unit on, if all connections were properly made the unit will power as normal and the display will show the start up screen.

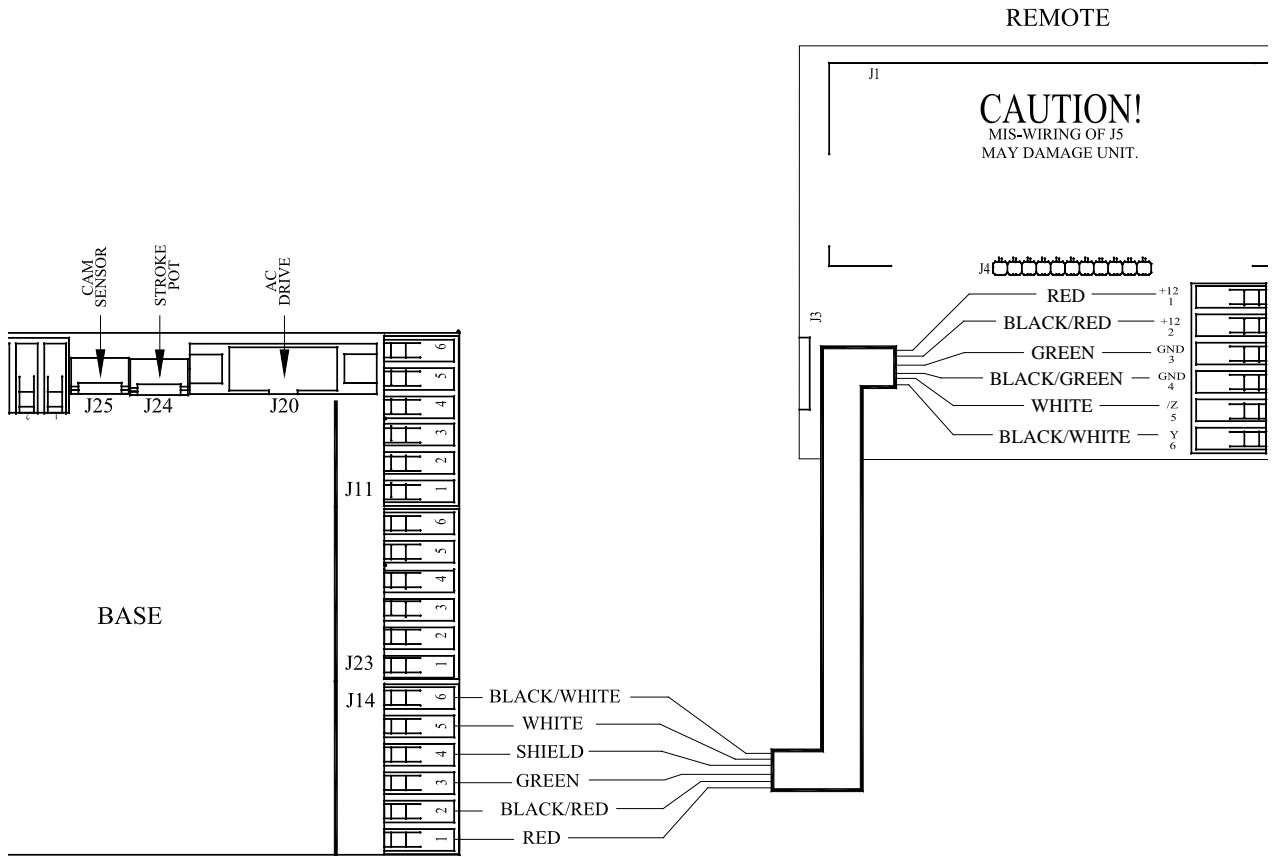

Figure 5a – Handheld Remote Wiring

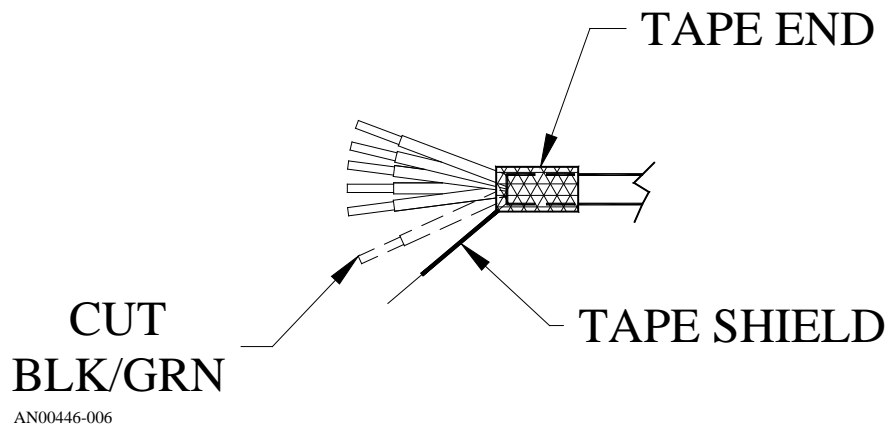
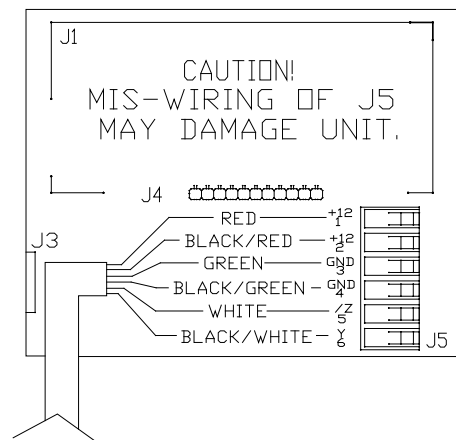
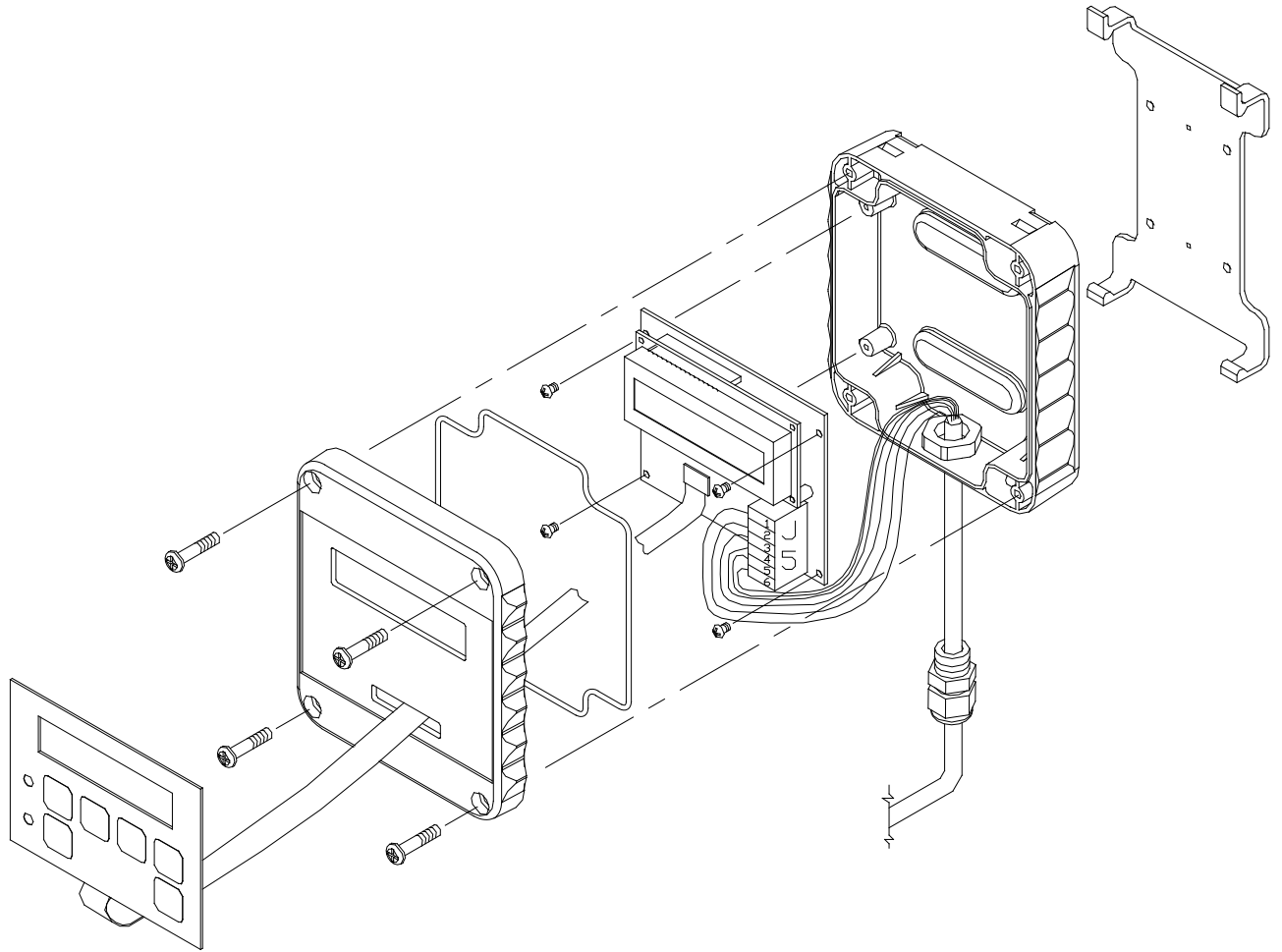

Figure 5b – Wire Preparation Detail, Base Unit End



WIRING DIAGRAM

AN0446-005

Figure 6 – Handheld Remote

13. Specifications

Turndown: Up to 1000:1 with a steady state accuracy of +/- 2 % (added to pump accuracy rating)

3:1 with a steady state accuracy of +/- 1 % (added to pump accuracy rating)

Operation mode: AC motor speed control with speed and stroke length feedback

Manual stroke length control

Power Requirements	Recommended Minimum Wiring and Circuit Breaker									
	115 VAC Operation					230 VAC Operation				
	Actual Draw	Circuit Breaker	Wire Size	Wire Size	Safety Approvals ¹	Actual Draw	Circuit Breaker	Wire Size	Wire Size	Safety Approvals ¹
MPC and 0.25 Hp motor	7.0 A	10 A	14 AWG	2.5 mm ²	UL, CUL, CE	3.5 A	10 A	14 AWG	2.5 mm ²	UL, CUL, CE
MPC and 0.33 Hp motor	7.0 A	10 A	14 AWG	2.5 mm ²	UL, CUL, CE	3.5 A	10 A	14 AWG	2.5 mm ²	UL, CUL, CE
MPC and 0.5 Hp motor	9.4 A	15 A	14 AWG	2.5 mm ²	UL, CUL, CE	5.2 A	10 A	14 AWG	2.5 mm ²	UL, CUL, CE
MPC and 0.75 Hp motor	16.8 A	25 A	12 AWG	4.0 mm ²	UL, CUL	9.4 A	15 A	14 AWG	2.5 mm ²	UL, CUL
MPC and 1.0 Hp motor	16.8 A	25 A	12 AWG	4.0 mm ²	UL, CUL	9.4 A	15 A	14 AWG	2.5 mm ²	UL, CUL
MPC and 1.5 Hp motor	24.2 A	35 A	10 AWG	6.0 mm ²	UL, CUL	12.2 A	20 A	14 AWG	2.5 mm ²	UL, CUL

NOTE: AC drive capacitors will cause in-rush current demand when power is first applied to the unit. Applicable national and local electrical codes take precedence over recommendations in these tables.

Control Inputs	Wiring	Specification / Description
Analog In #1	J11 pins 4-6	4-20mA control signal Max current 30mA; Input resistance 200 Ohm Internally protected with resettable fuse Minimum signal accepted = 2.4 mA Maximum signal accepted = 24 mA
Analog In #2	J11 pins 5-6	Not presently available – future release
Digital In #1	J11 pins 1-3	User to provide dry-contact input *

Digital In #2	J11 pins 2-3	User to provide dry-contact input *
		*All digital inputs require a dry contact input (maximum of 2K Ohm contact resistance to register as “active”). Do not apply power to these terminals.

* Digital input functions:

1. Remote on/off control of metering pump
2. Level input from supply tank
3. Leak detection of the metering pump
4. Flow detection, with use of external flow switch accessory

Control Outputs	Wiring	Specification / Description
Analog Out #1	J23 pins 5-6	4-20mA output for pump flow indication Max voltage out 12 Volts; Max current out 30mA; Max load resistance 300 Ohm Internally protected with resettable fuse
Digital Out #1	J23 pins 1-4	Transistor-based output, various functions *
Digital Out #2	J23 pins 2-4	Transistor-based output, various functions *
Digital Out #3	J23 pins 3-4	Transistor-based output, various functions *
		All digital outputs maximum 40 VDC, maximum 500 mA NOTE: requires external power source

* Digital output functions:

1. Triggering an external relay due to a fault condition
2. Auto/Manual status
3. On/Off status
4. Pulse output – Indication each time the pump strokes
5. Leak detection status indication
6. Tank level status indication

Calibration: Controller includes an on board program for signal and flow calibration.

Input Voltage: 115 (105-125 acceptable range) or 230 (208 – 240 acceptable range) VAC
Note: factory configured only for correct input voltage range (specified at time of purchase) Single phase input only 50 or 60 Hz.
Input frequency range 48 Hz to 62 Hz

Motor Req: Commercially available motor supplied by the manufacturer of the pump controller.

	Standard selection is rated for indoor, dry environment, other options available
Keypad:	Can be mounted on the pump or up to 1000' away from the pump Standard cable length 6 feet
Display:	Backlit 2 line extended temperature 16 character LCD
Enclosure:	NEMA 4X and IP56 ratings
Altitude:	3300 Ft (1000 M) above sea level (de-rate 5% per additional 3300 Ft).
Humidity:	0-90% (non-condensing)
Temperature:	0° C (32° F) Minimum operating temperature 40° C (104° F) Maximum operating temperature
Earth Leakage Current:	Size Earth Leakage Circuit Breakers (ELCB) to a detection level of 30 mA or greater
Transient Voltage	Max Impulse withstand 1500V (115VAC Models), 2500V (230VAC Models) at 50uS
Voltage Overload	150% for 60 seconds or 180% for 30 seconds
Pollution Degree	Suitable for Pollution Degree 1 environment only (conduit entries must be sealed against ingress of fluids and vapors)

14. Menu Maps

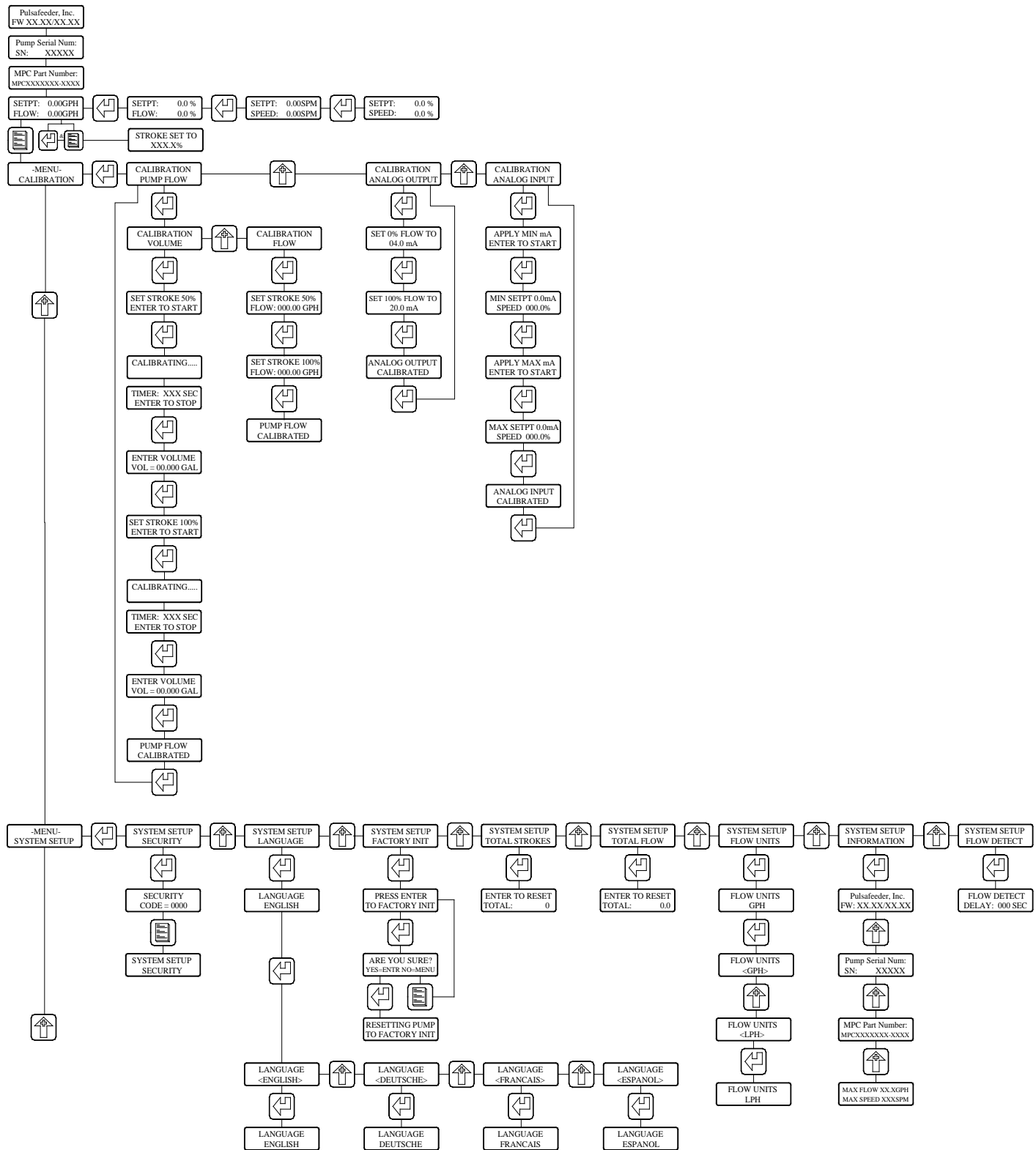

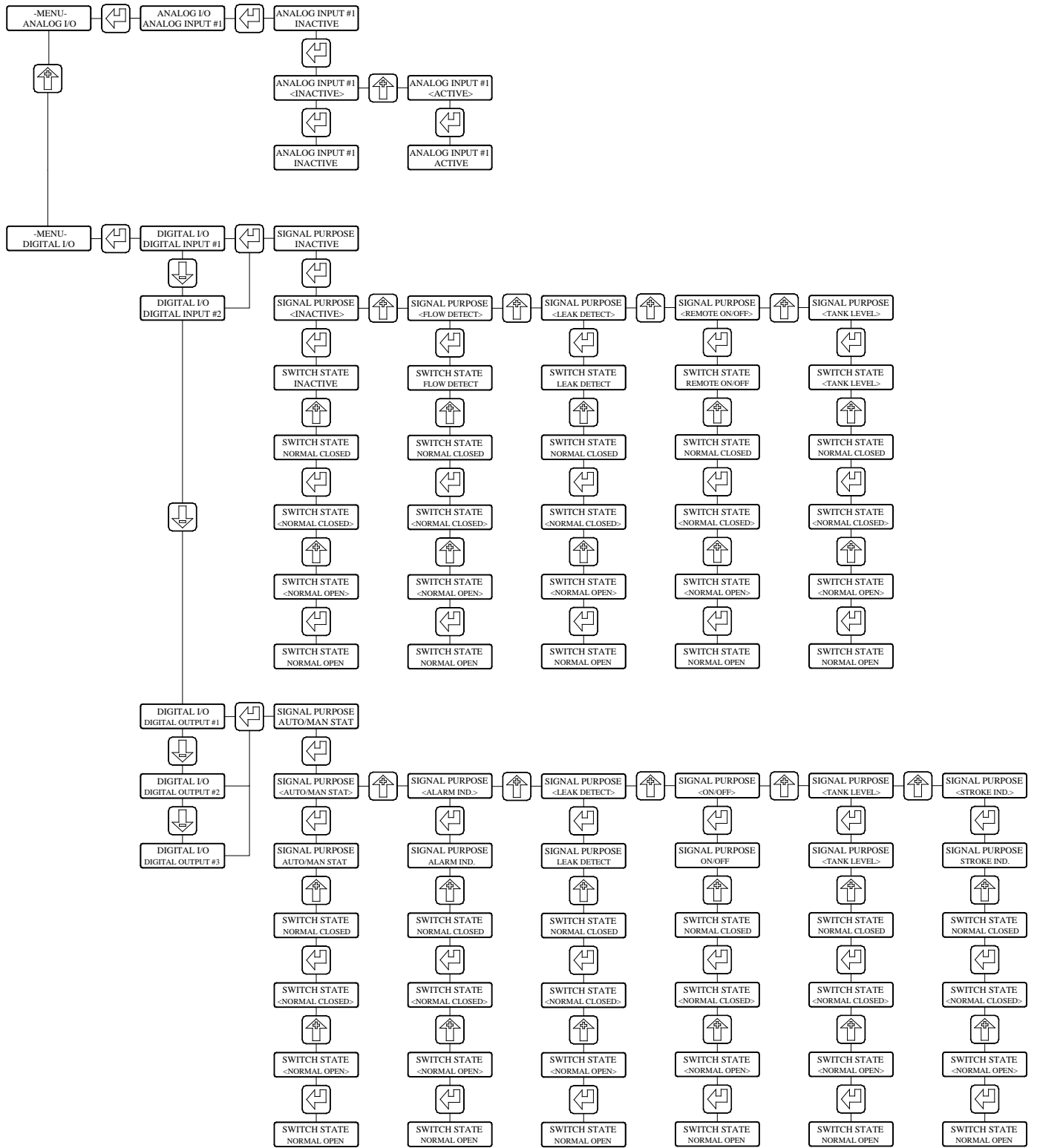

15. Factory Default Values

Parameter	Factory Set Value
Digital Input #1	INACTIVE, normally closed
Digital Input #2	INACTIVE, normally closed
Analog Input #1	INACTIVE
Analog Input #2	NOT AVAILABLE this revision
Digital Output #1	STROKE Indication, normally closed
Digital Output #2	AUTO/MANUAL Indication, normally closed
Digital Output #3	Alarm Indication, normally closed
Security Code	Default = 0000
Language	ENGLISH
MODE	Local (Manual)
UNITS	GPH (gallons per hour)

16. Retrieval of Setup Information

Users can access the system setup: information menu, which will list the following data, this may be helpful in troubleshooting:

- Controller software revisions
- Pump serial number
- MPC model number
- Pump maximum flow
- Pump maximum speed

17. Special Keypress Access

In This SCREEN	Press MENU and ENTER at the same time to:
SETPT XX.XXX FLOW XX.XXX	View the stroke position of the pump
MENU ANALOG I/O	Show calibration and RAW data for analog inputs
MENU DIGITAL I/O	Shows current status of digital inputs and outputs Press DOWN arrow to see digital out #3

Press the MENU key to exit from any of these special screens.

18. Troubleshooting Guide

Problem	Potential Cause	Solution
---------	-----------------	----------

DISPLAY		
---------	--	--

No Display	No power supplied.	Check power source. plug & circuit breaker
Back-lighting	Supply power wired incorrectly.	Check wiring.
	Supply power outside of specification.	Check voltage/frequency against specification.
No Text on Display	Contrast out of adjustment.	Adjust as per section 10.8
	Software did not initiate properly.	Remove and re-apply Ac power

POWER		
-------	--	--

No power	No power supplied.	Check power source. Plug & Circuit Breaker
Indicators	Supply power wired incorrectly.	Check wiring.
	Supply power outside of specification.	Check voltage/frequency against specification.

19. Maintenance & Spare Parts



All maintenance work must be carried out only when the MPC and connected equipment is stopped and disconnected from mains supply (including auxiliary circuits). Maintaining original characteristics over time must be ensured by an efficient maintenance and inspection plan, developed and managed by qualified technicians, taking into account the service and the actual environmental conditions in which it operates.

19.1 Operating Precautions

All operations must be performed by qualified personnel.

Work on the unit should only be performed with safety supervisor authorization, after having verified that:

- a) Disconnect power at the source (follow your local lockout tag out procedures)
- b) The power line is disconnected and no parts are energized, including any auxiliaries
- c) Ensure that any risk of accidental restart has been excluded
- d) Consult Manufacturers Pump Operating Manual for instructions on minimizing risk due to pressurized or chemically dangerous conditions with in the Pump system
- e) **With pump switched off**, that the ON-OFF valves on the suction and discharge pipelines are closed.
- f) Pump has been adequately cleaned, when operating in environments exposed to aggressive chemicals
- g) Maintenance personnel shall refer to the ***Installation and Wiring*** section

for safe return to service

after repair

Since the machine object of supply is a product designed and intended for operation in industrial areas, additional measures must be adopted and assured by the person responsible for the installation, should more restrictive safety conditions be required.

19.2 Cleaning and Decontamination

The MPC enclosure may be cleaned with water and mild detergent. Decontamination shall occur when the MPC is exposed to a release of process chemicals. Follow the SDS for clean-up in the event of a chemical spill.

19.3 User Replaceable Parts for the MPC

Pulsafeeder P/N	Description
W770401-188	Housing cover bolt
W774030-188	Housing cover washer
NP460056-000	Housing cover gasket
NP530091-000	½" wiring liquidtight connector
NP530137-000	¼" wiring liquidtight connector
NP530511-006	Hand-held unit (complete)
NP140070-000	Hand-held unit angle-mount bracket
NP140066-PVC	Hand-held unit "snap-in" bracket
W213946-NTR	Hand-held enclosure gasket
NP550113-000	Membrane keypad for hand-held
NP530130-000	Cable, for hand-held, 6 foot length
NP83XXXXXP-XXXX	Stroke cover with position sensor
NP030013-000	Bearing cap with eccentric sensor
W772568-STL	½" conduit opening plug
W772585-018	¼" conduit opening plug

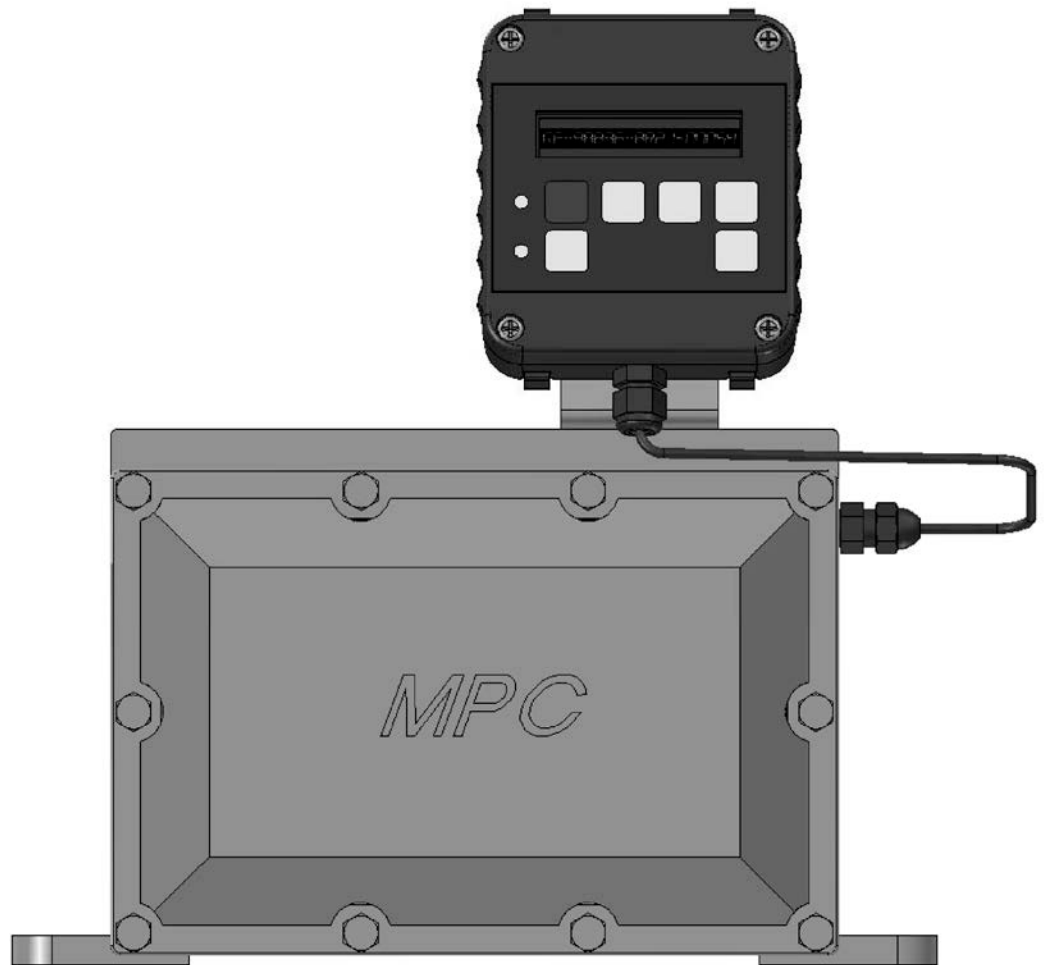

IOM-CTL-2000-Rev.I

MPC[®] SPEED CONTROLLER



A unit of IDEX Corporation
2883 Brighton Henrietta Town Line Road
Rochester NY 14623
+1 (585) 292-8000
pulsa.com
pulsa@idexcorp.com

